

A	B	C	D	A	B	C	D		
1	S162-0010	1543	494	4/5	14	S162-3310	488	540	3/5
2	S162-0011	404	494	5/5	15	S162-4405	488	60	3/5
3	S162-0012	404	494	5/5	16	S162-4441	2008	60	1/5
4	S162-0014	1543	494	4/5	17	S162-4440	996	60	3/5
5	S162-0040	1002	176	5/5	18	S162-504	1493	29	1/5
6	S162-1150	2050	540	1/5	19	S162-9940	2000	506	1/5
7	S162-1115	2050	540	1/5	20	S162-9942	969	505	3/5
8	S162-1116	1975	540	2/5	21	S162-9912	2000	510	1/5
9	S162-1151	1975	540	2/5	22	ZS3-529	500	100	3/5
10	S162-2205	2042	566	2/5	23	ZS3-530	500	100	3/5
11	S162-3350	996	540	3/5	24	S162-540	947	100	3/5
12	S162-3351	2008	540	1/5	25	dr-992	992	30	3/5
13	S162-3309	487	539	3/5	26	Lh-1970	1970	14	1/5

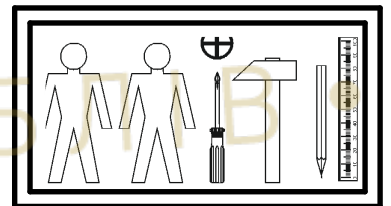
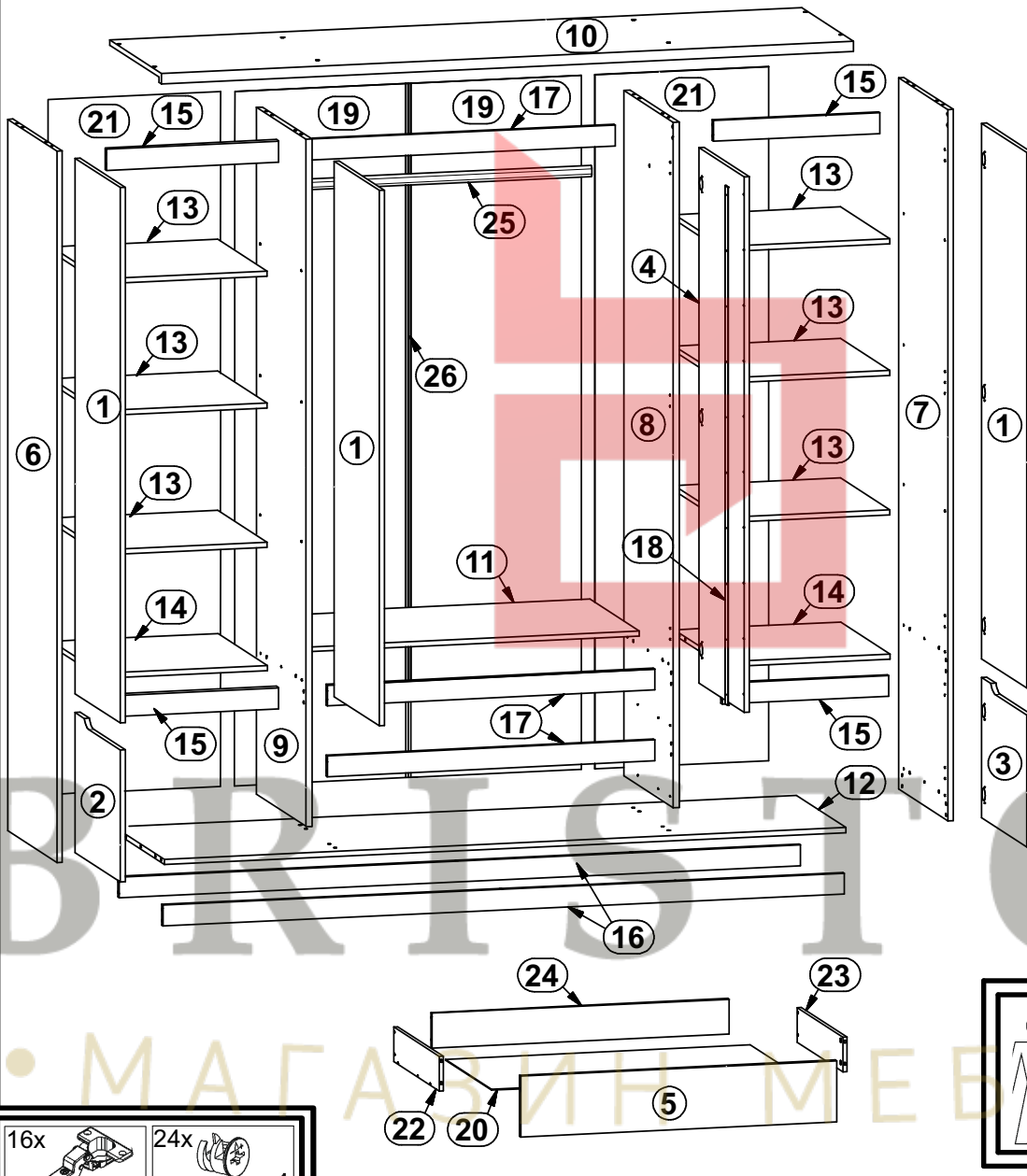
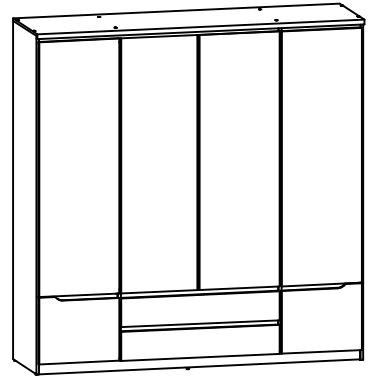

16x a68	24x r1 Ø15x12 mm #16
16x b19	24x d1 Ø5x17 mm
6x k1	150x l1
8x r15 Ø12x10.5 mm #12	32x r42

12x e1 Ø7x50 mm	12x e19 Ø5x9 mm	32x e2 Ø6.3x13 mm	12x e3 Ø6x13 mm	52x f1 Ø8x30 mm	8x f6 Ø8x50 mm	8x f25 Ø6.5x40 mm
1x n56 32x16x1511 mm	2x n158	2x p1 Ø3.5x13 mm	2x p27 Ø3.5x13 mm	18x p38 Ø3.5x16 mm	32x p51 Ø3.5x15 mm	2x p25 Ø3.5x16 mm
2x w26ICL 500 mm	2x w26ICR 500 mm	2x w26IDL 500 mm	2x w26IDR 500 mm	1x z1	2x t34 500 mm	2x p35 Ø3.5x10 mm

1 

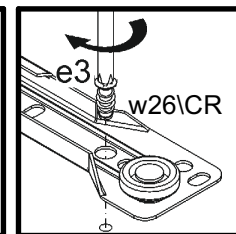
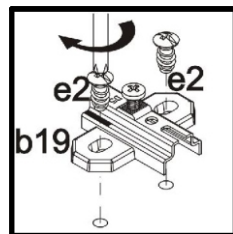
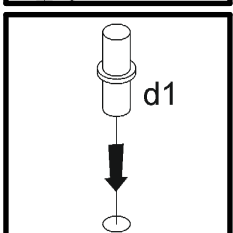
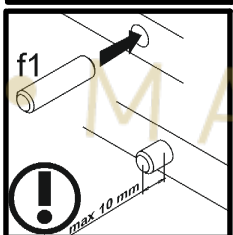
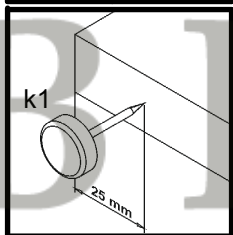
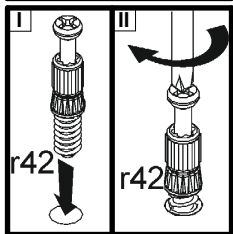
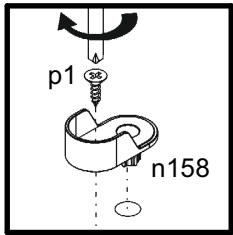
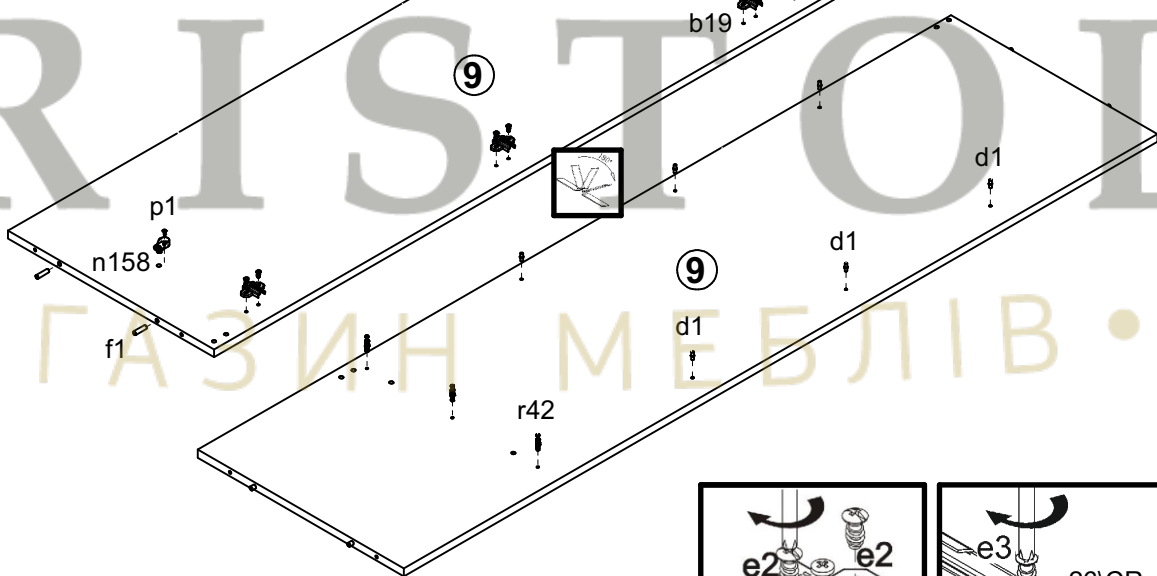
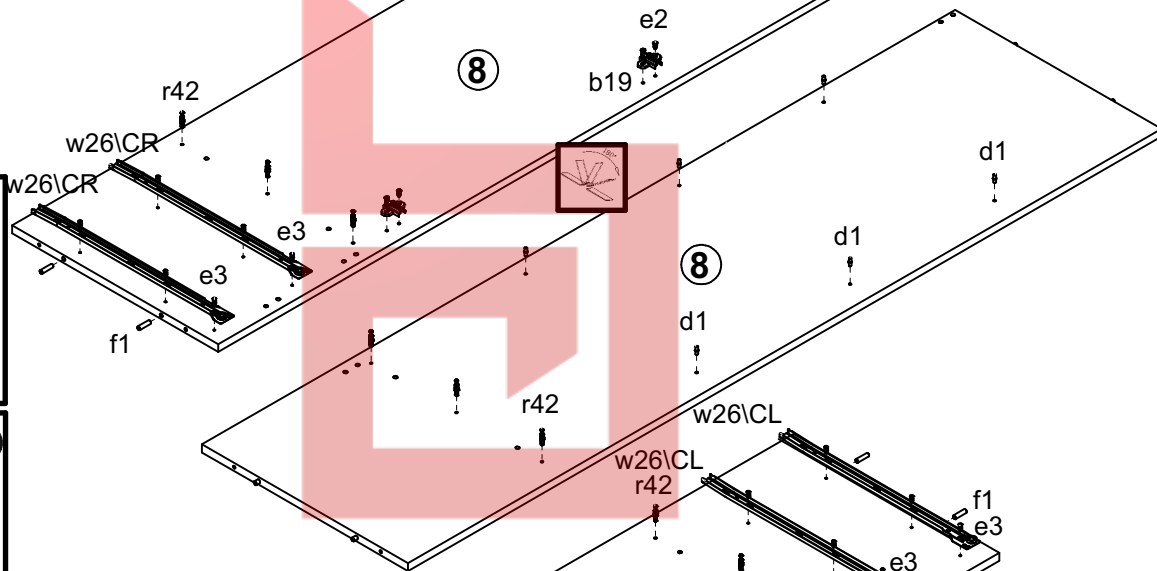
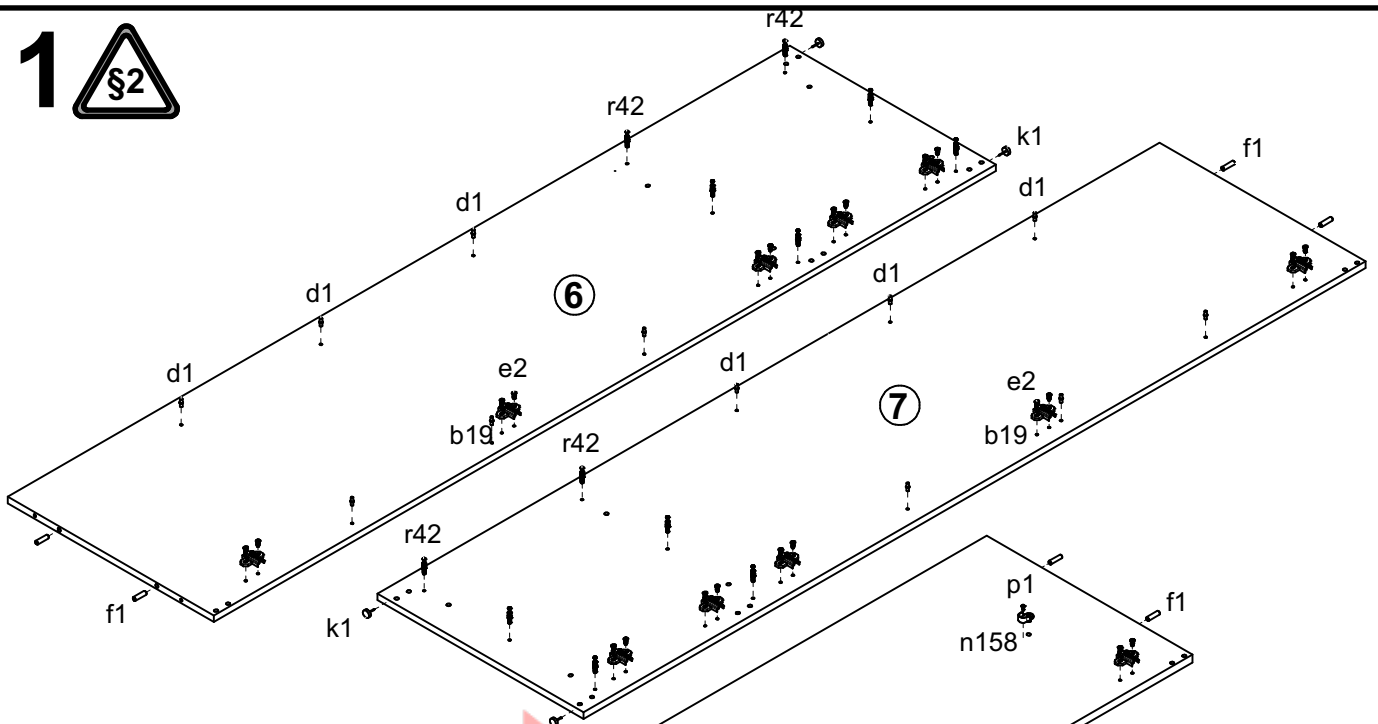

2

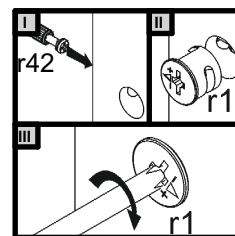
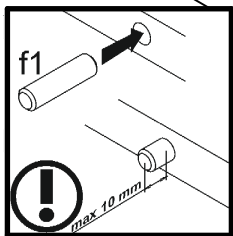
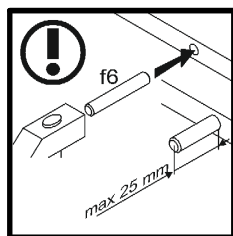
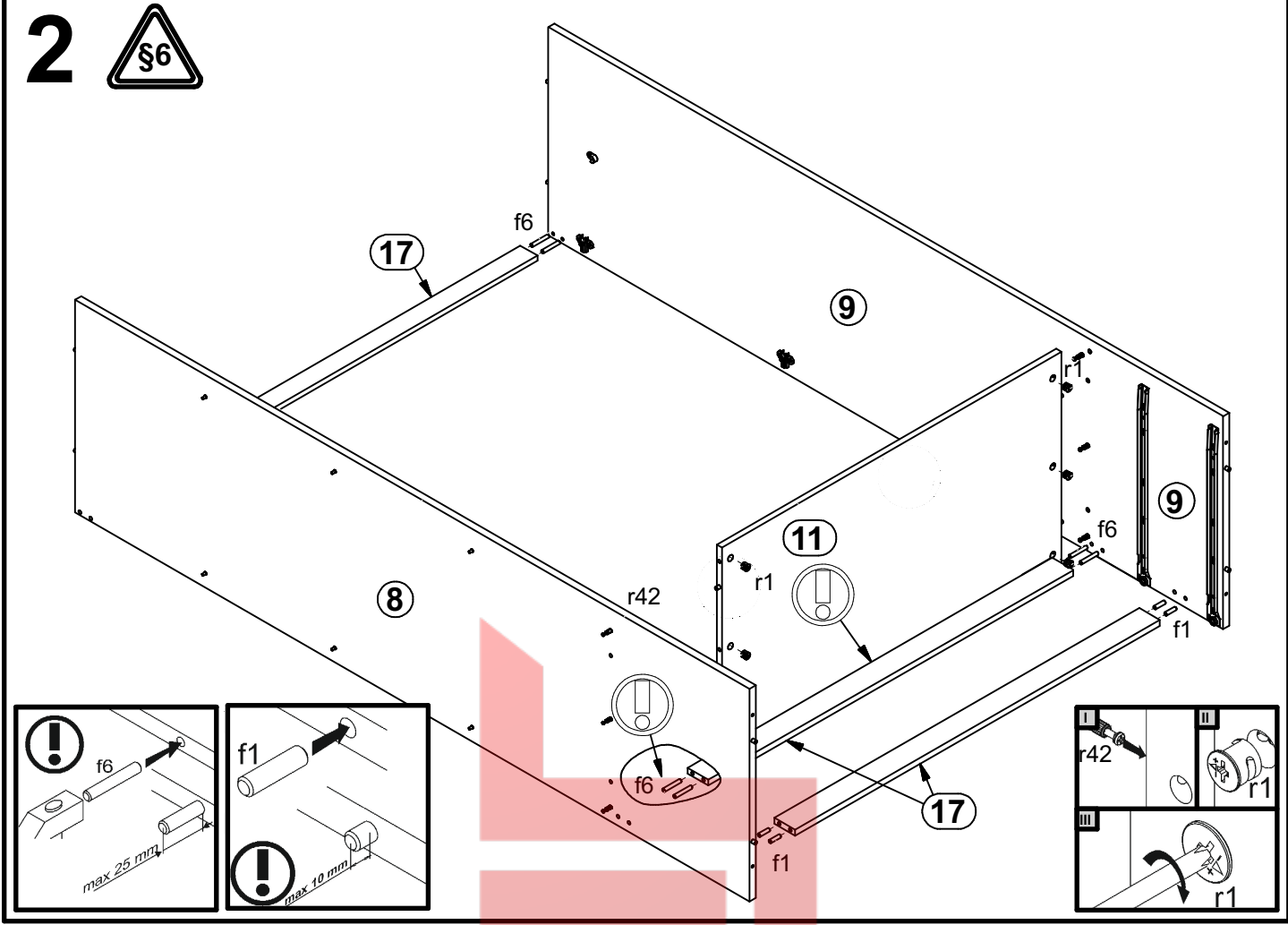

3

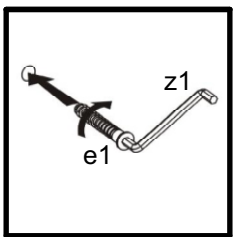
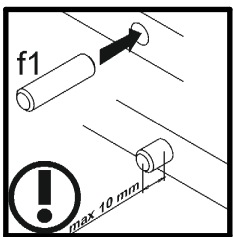
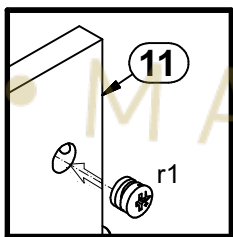
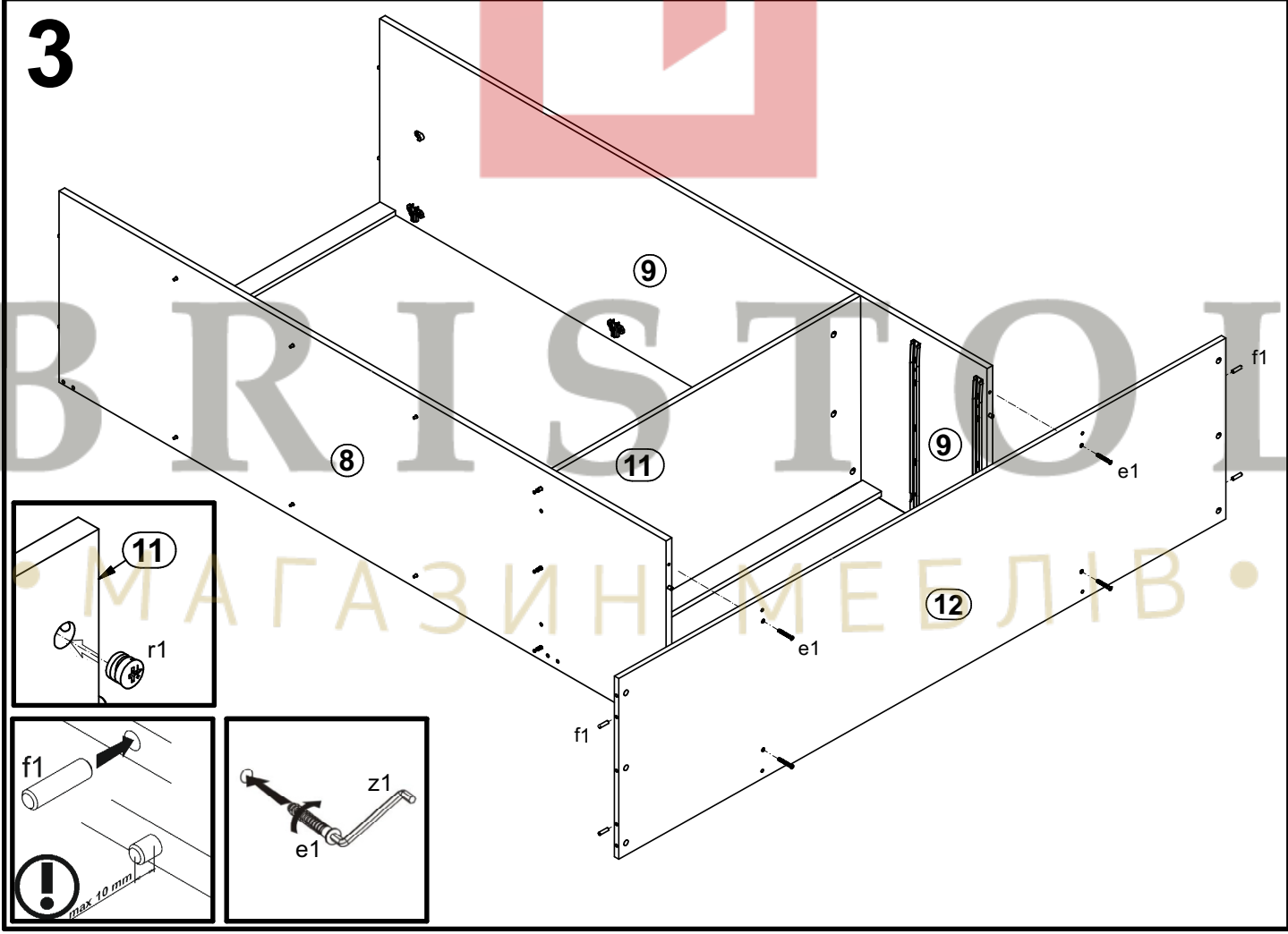

5

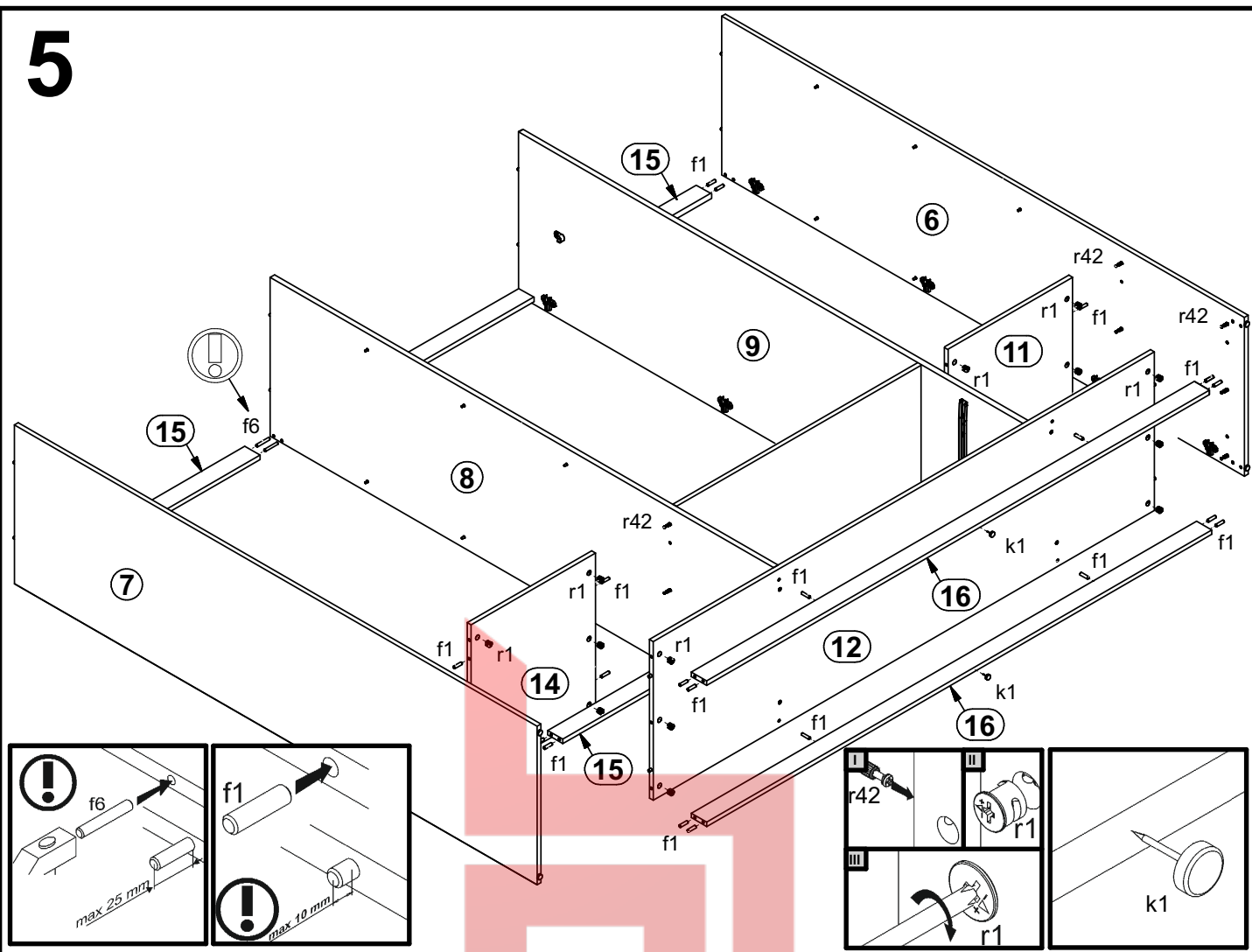

6

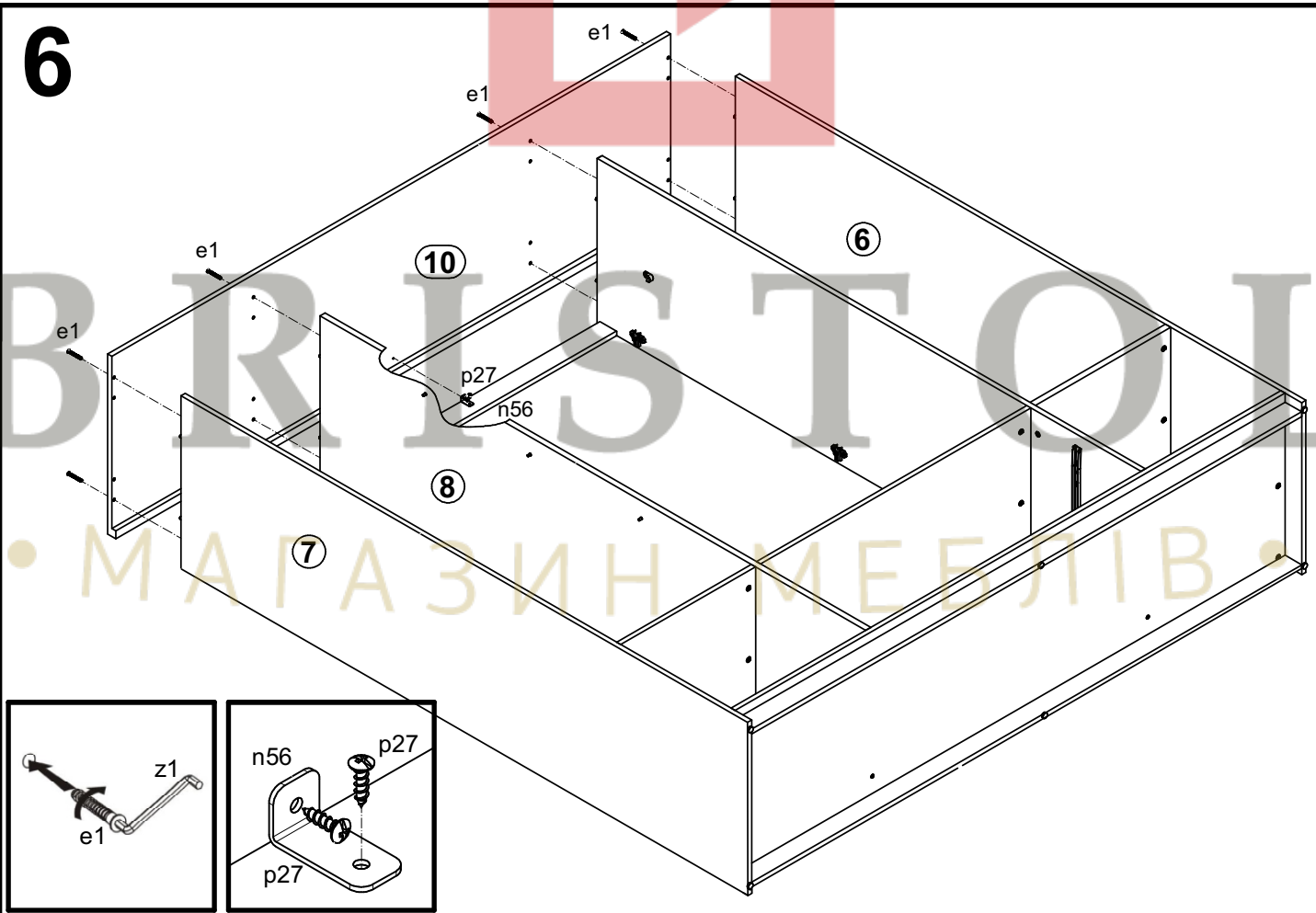

7

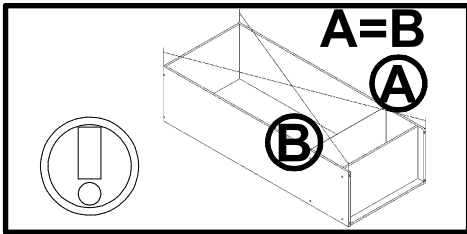
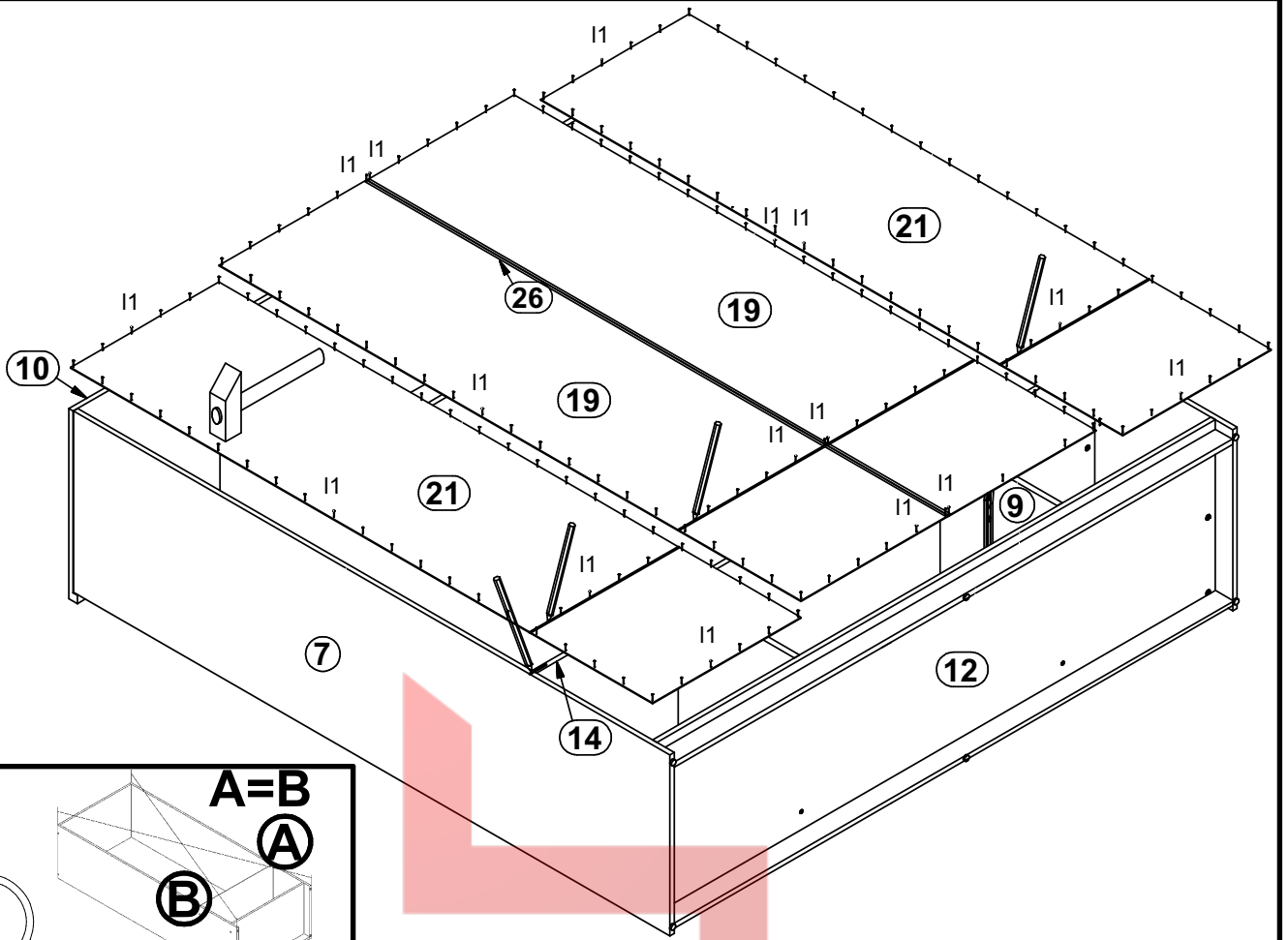

8

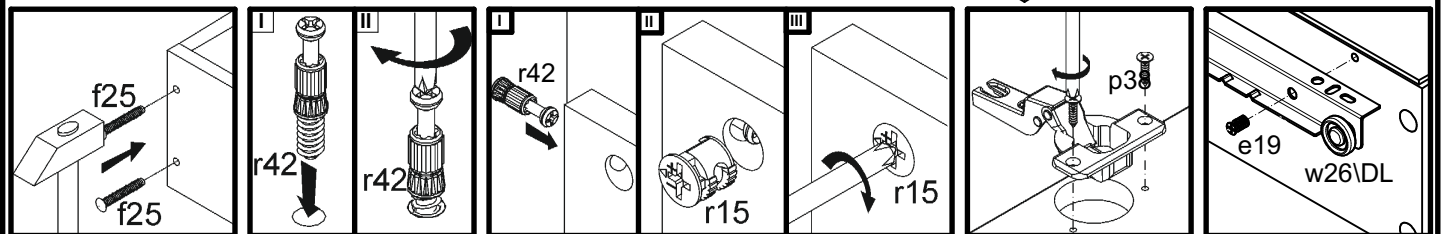
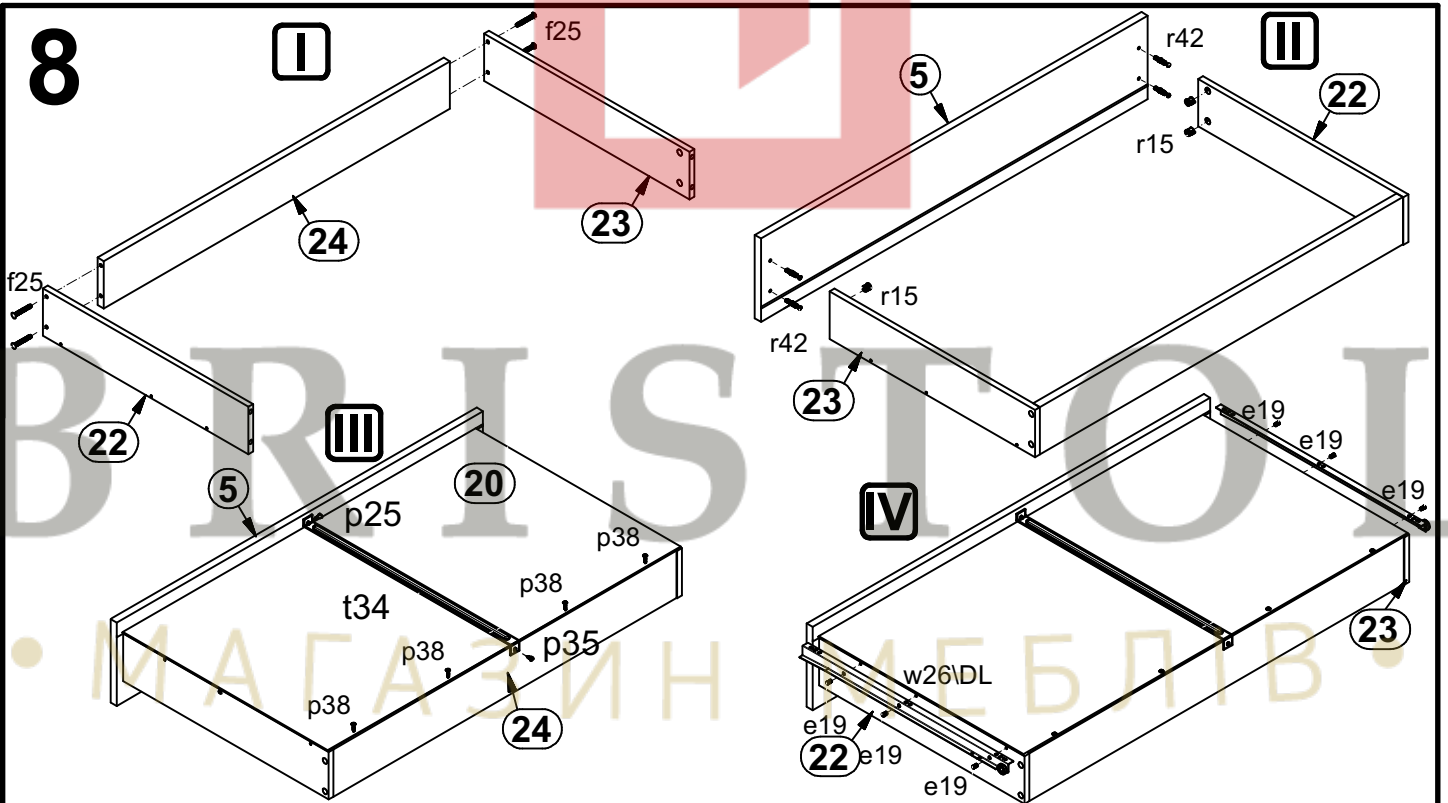

9

