

A	B	C	D
1	S52-011A	496	167 3/3
2	S52-118	1988	370 1/3
3	S52-119	1988	370 1/3
4	S52-206	500	395 2/3
5	S52-309	467	370 2/3
6	S52-310	467	365 2/3
7	S52-408	467	80 2/3
8	S52-409	498	56 2/3
9	S52-503	350	120 2/3
10	S52-504	350	120 2/3
11	S52-508	418	120 2/3
12	S52-907	428	348 2/3
13	S52-9904	1944	493 1/3

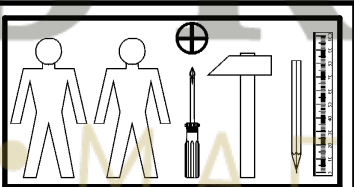

2x 160 mm c128	16x $\phi 5 \times 17$ mm d1	4x $\phi 7 \times 50$ mm e1	12x $\phi 6 \times 13$ mm e3	16x $\phi 8 \times 30$ mm f1	8x $\phi 6.5 \times 40$ mm f25	4x k1	55x l1	2x l37
4x $\phi 4 \times 30$ mm p9	8x $\phi 3.5 \times 12$ mm p54	10x $\phi 1.5 \times 12$ mm #16 r1	8x $\phi 1.2 \times 10.5$ mm #12 r15	18x r16	4x s1	4x $\phi 16$ s2	2x 350 mm w45\CL	2x 350 mm w45\CR
2x 350 mm w45\DL	2x 350 mm w45\DR	1x z1	1x n26\1	1x $\phi 3.5 \times 16$ mm p38				

1 

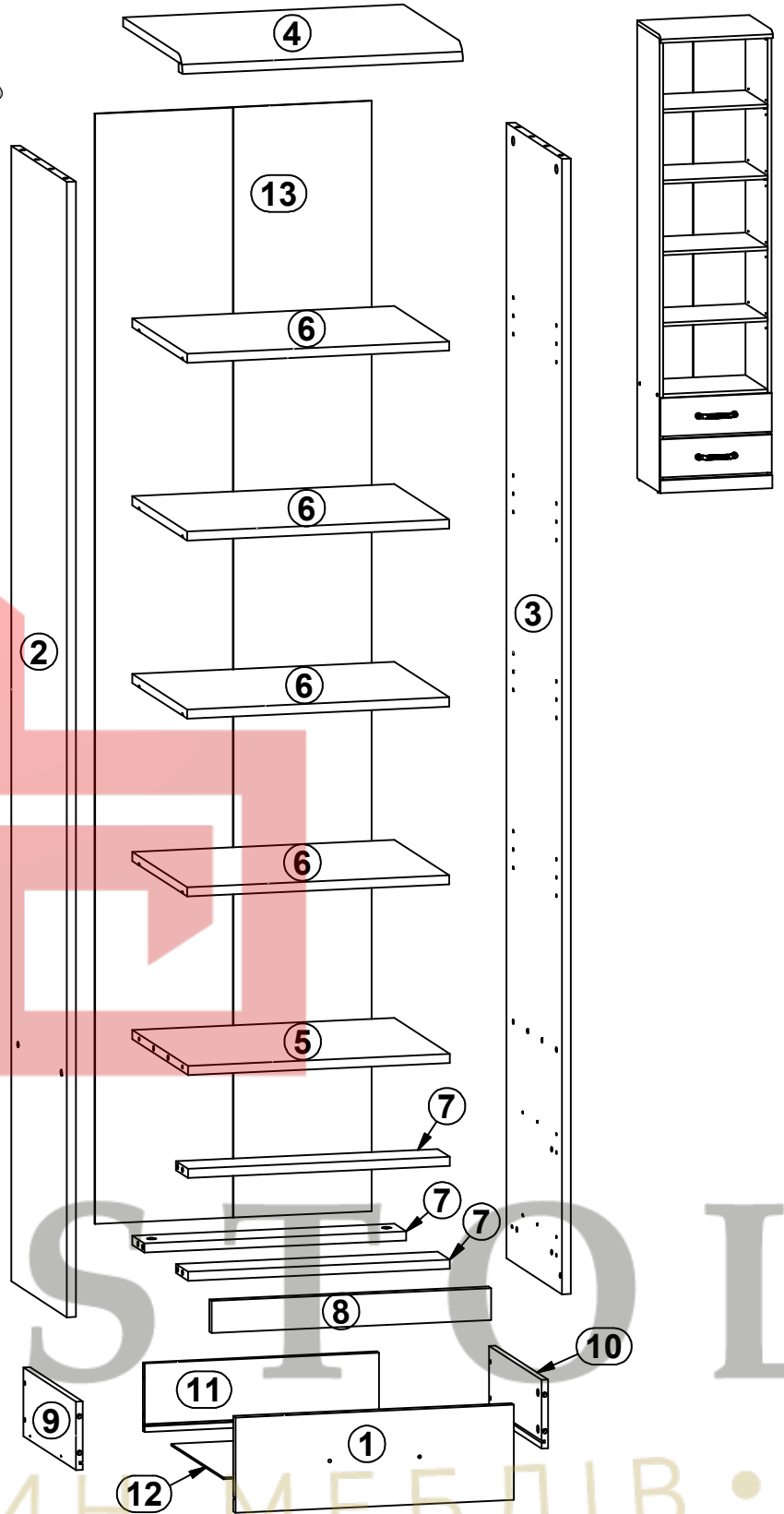
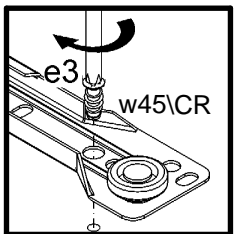
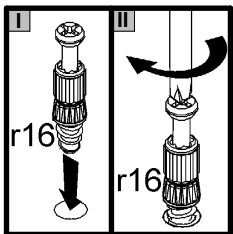
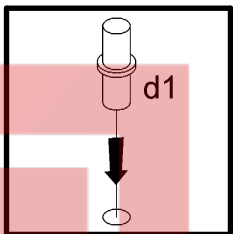
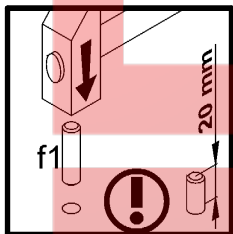
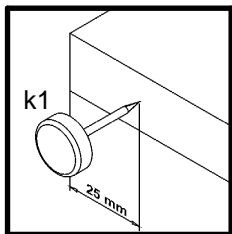
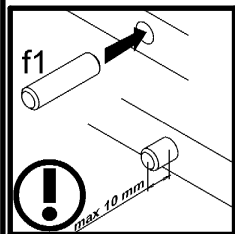
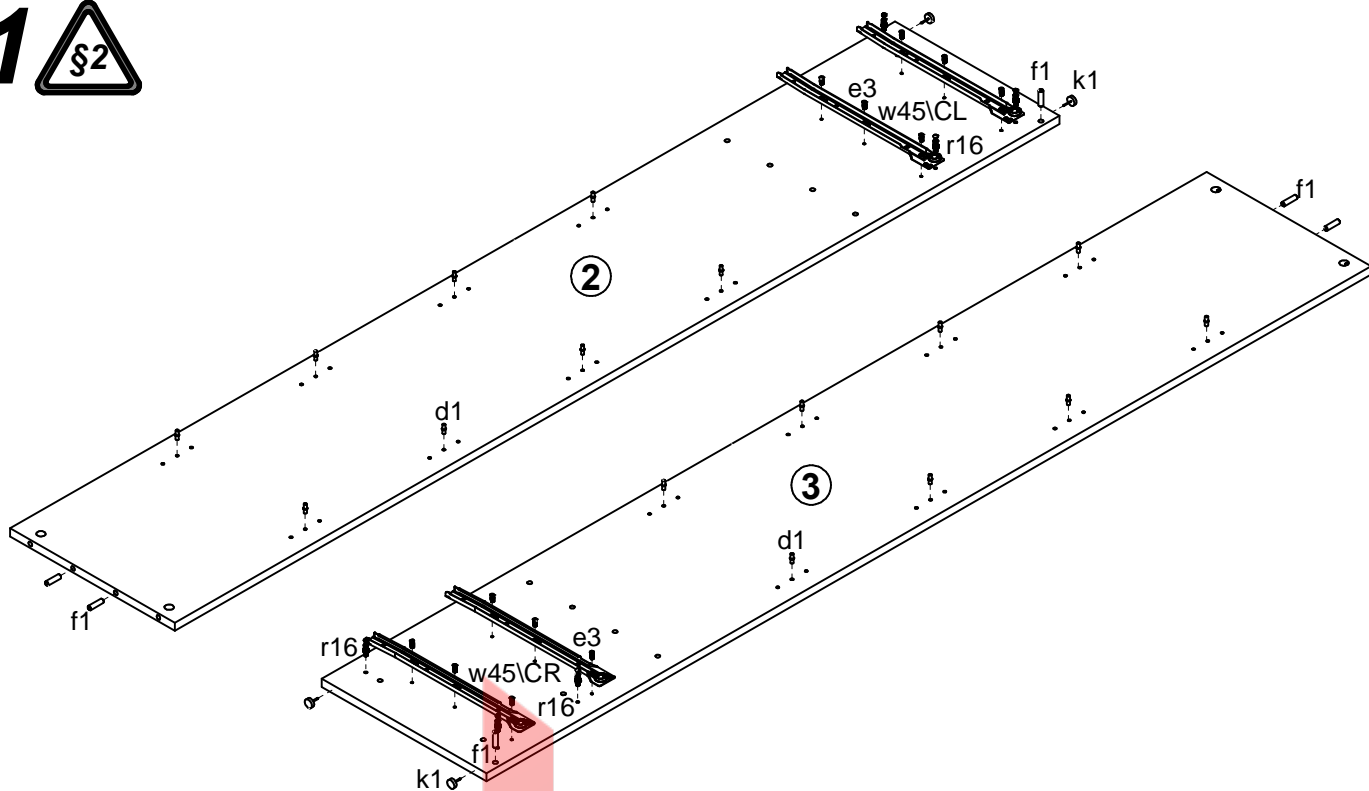

2 

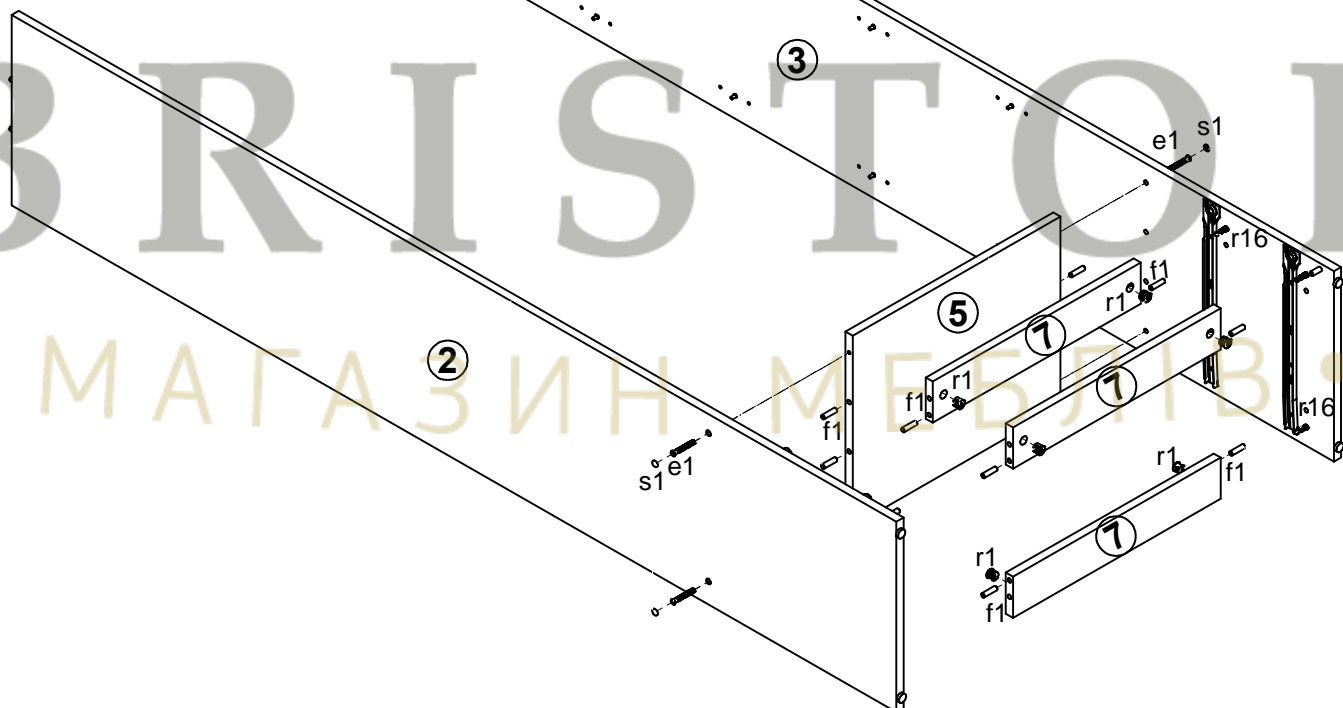
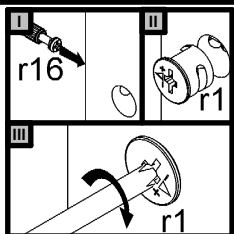
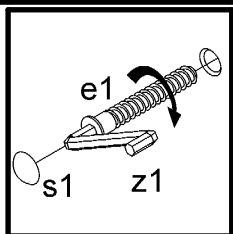
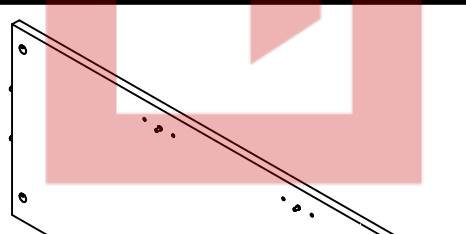
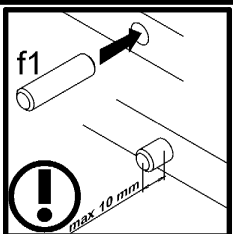

3

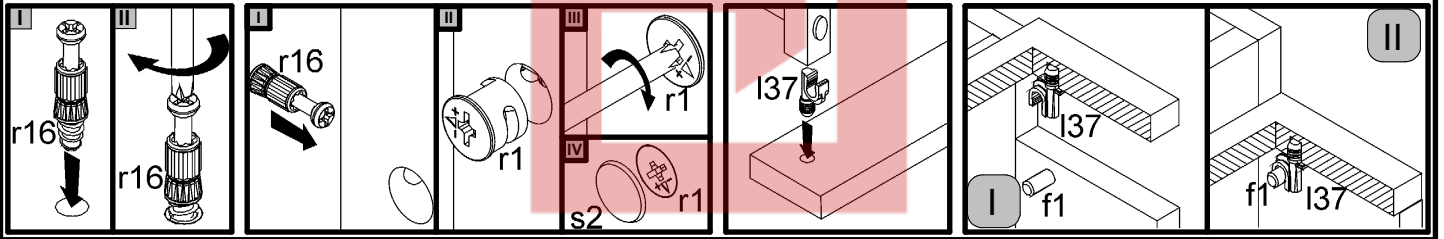
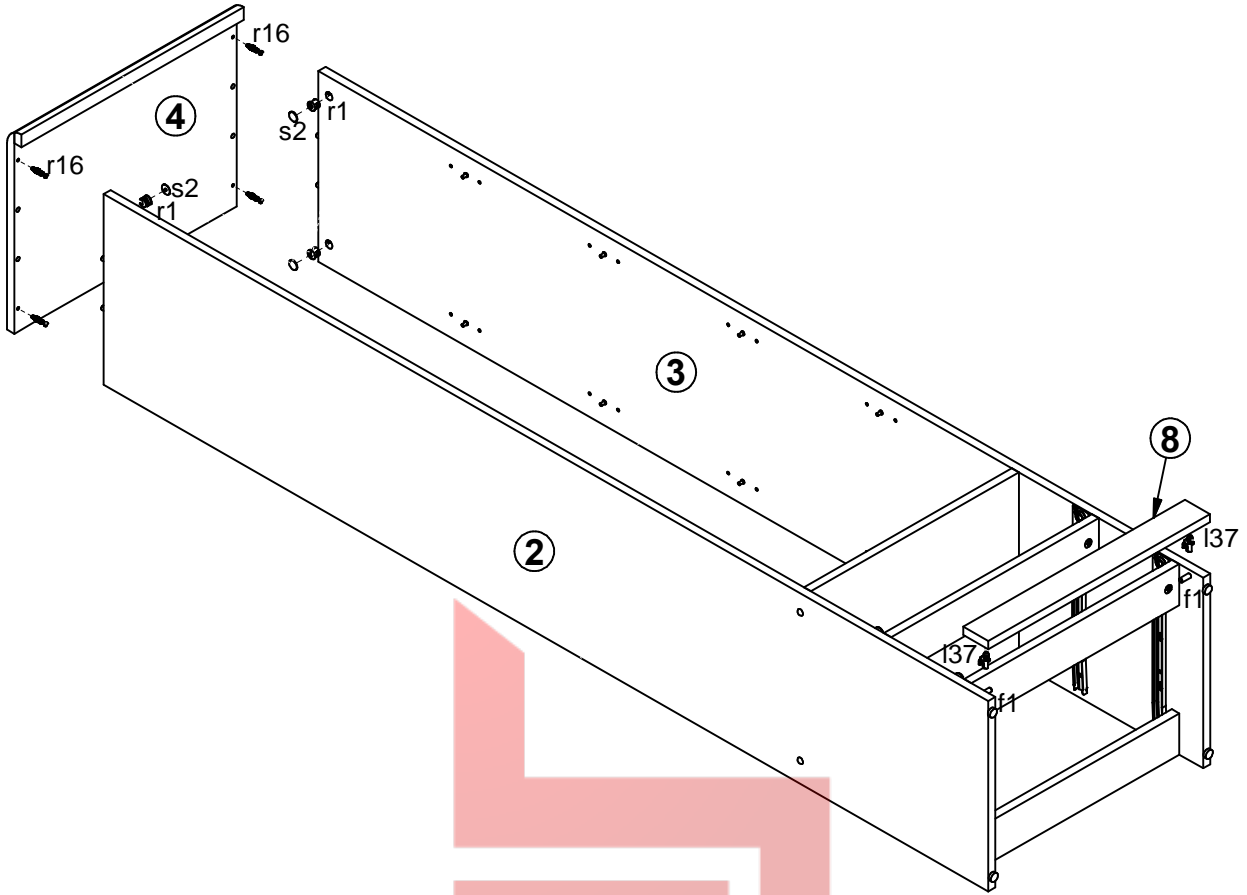

4

