

# CEHA / SEINE

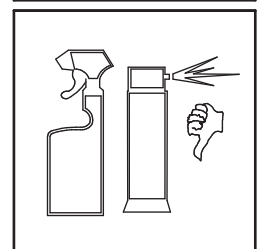

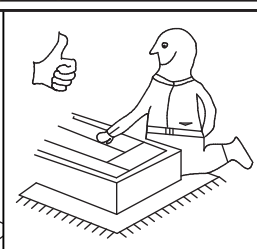

4x  K16 <b>a43</b>	8x  K0 <b>a44</b>	2x  K9.5 <b>a68</b>	14x  <b>b19</b>	7x  <b>c430/1</b>	4x  $\phi 5 \times 17$ mm <b>d1</b>
8x  $\phi 5 \times 17$ mm <b>d3</b>	24x  $\phi 7 \times 50$ mm <b>e1</b>	2x  $\phi 6,3 \times 13$ mm <b>e2</b>	4x  $\phi 5 \times 11$ mm <b>e4</b>	4x  $\phi 6,3 \times 13$ mm <b>e5</b>	44x  $\phi 8 \times 30$ mm <b>f1</b>
2x  <b>g2</b>	12x  M4x12 mm <b>j3</b>	10x  <b>k55</b>	25x  <b>l1</b>	38x  <b>l2</b>	1x  <b>m1/L</b>
1x  <b>m1/P</b>	2x  L-236 <b>m3</b>	1x  <b>n2</b>	1x  50x12\1,5 mm <b>n3</b>	2x  <b>n10/1</b>	1x  81x21x15\1,5mm <b>n14</b>
2x  <b>n122/1</b>	16x  <b>o1</b>	4x  $\phi 8 \times 1,8$ mm silikon <b>o21</b>	4x  <b>o43/1</b>	1x  <b>o43/6</b>	
12x  $\phi 3,5 \times 13$ mm <b>p1</b>	20x  $\phi 4 \times 35$ mm <b>p6</b>	10x  $\phi 4 \times 30$ mm <b>p9</b>	2x  $\phi 2,5 \times 13$ mm <b>p15</b>	4x  $\phi 4 \times 30$ mm <b>p21</b>	4x  $\phi 3,5 \times 13$ mm <b>p27</b>
4x  $\phi 4 \times 20$ mm <b>p39</b>	8x  $\phi 2,9 \times 24$ mm <b>p50</b>	28x  $\phi 3,5 \times 15$ mm <b>p51</b>	26x  $\phi 15 \times 12$ mm #16 <b>r1</b>	26x  20/9 <b>r16</b>	22x  $\phi 16$ <b>s2</b>
1x  <b>z1</b>					

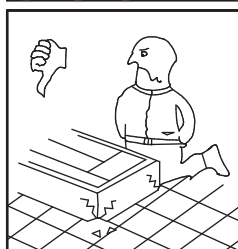
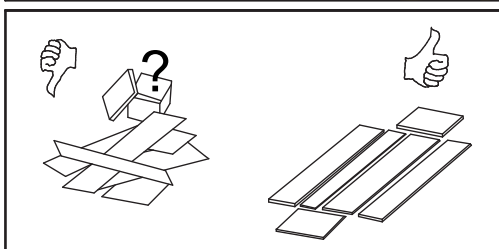
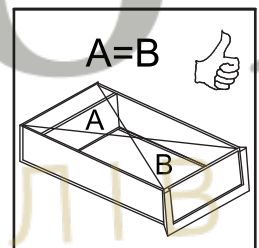
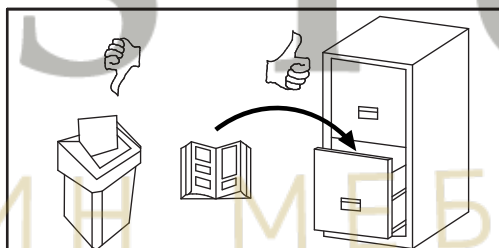
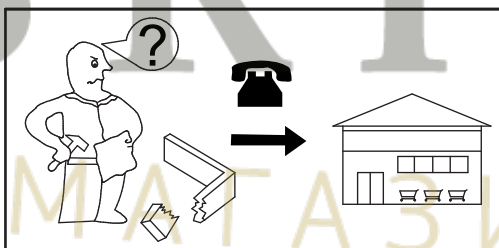
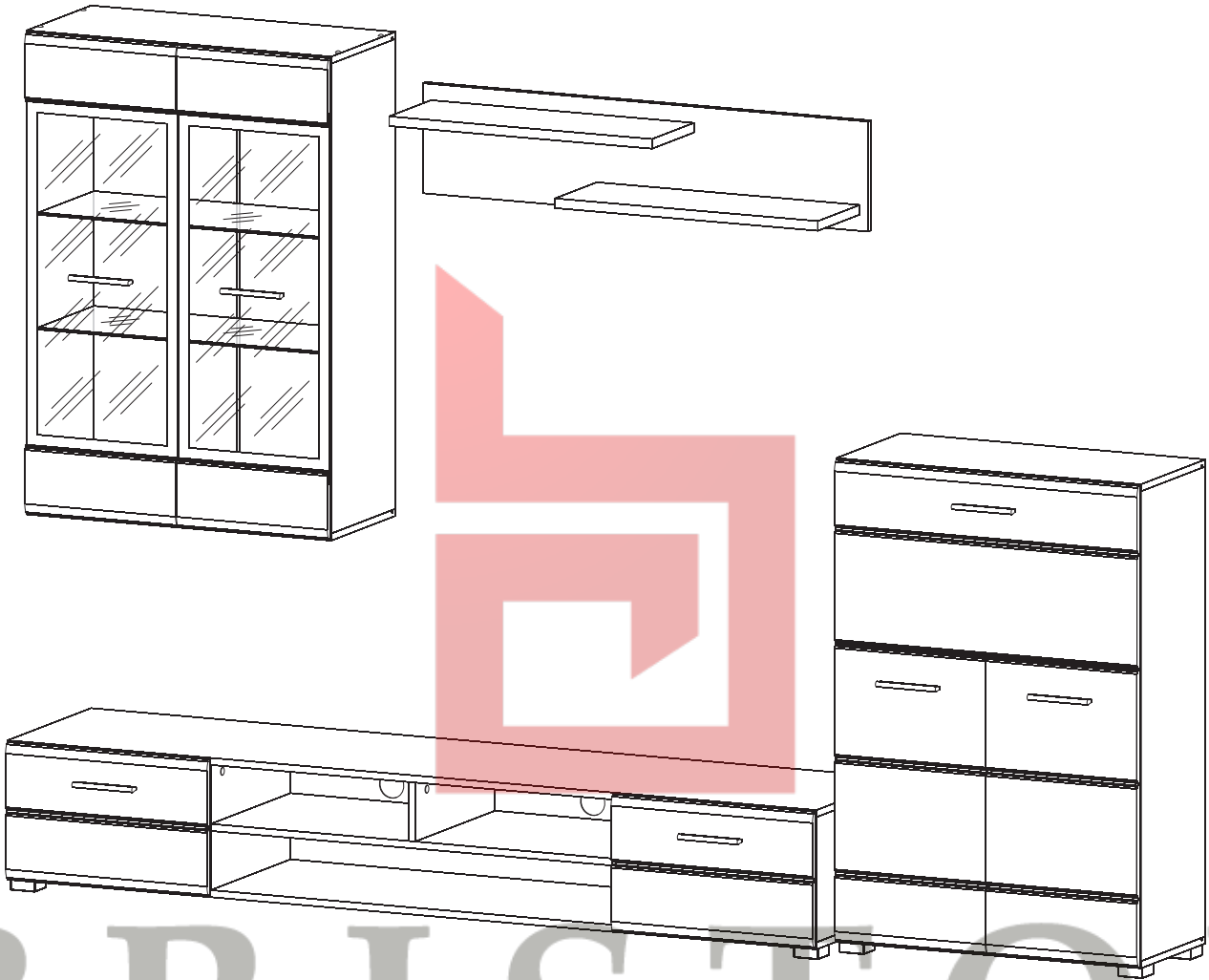
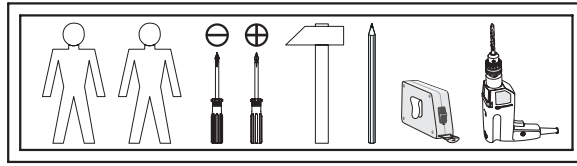
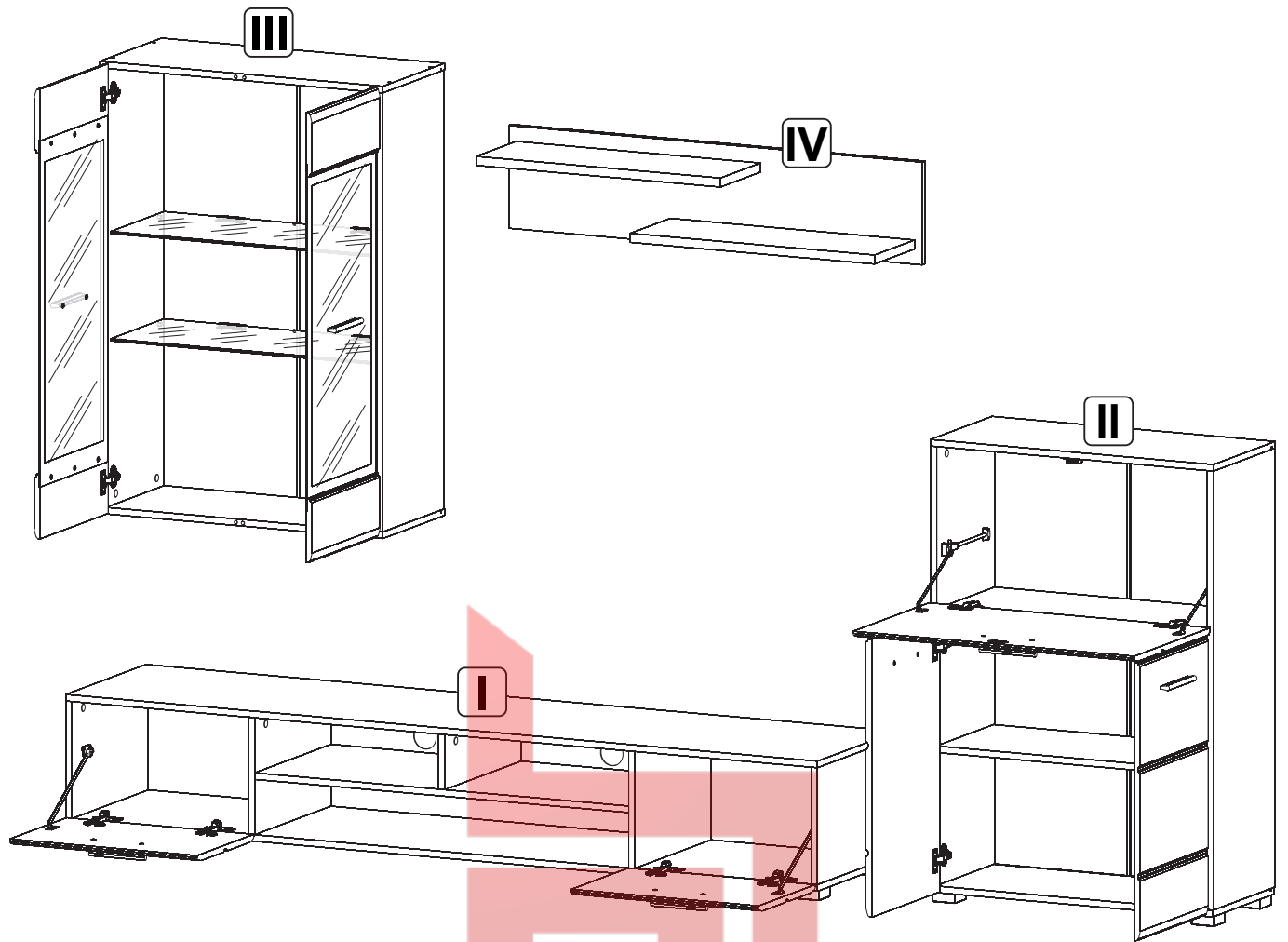
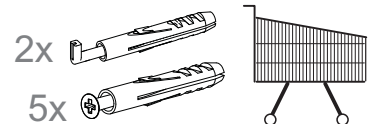

**I** Тумба PTB / Szafka RTV

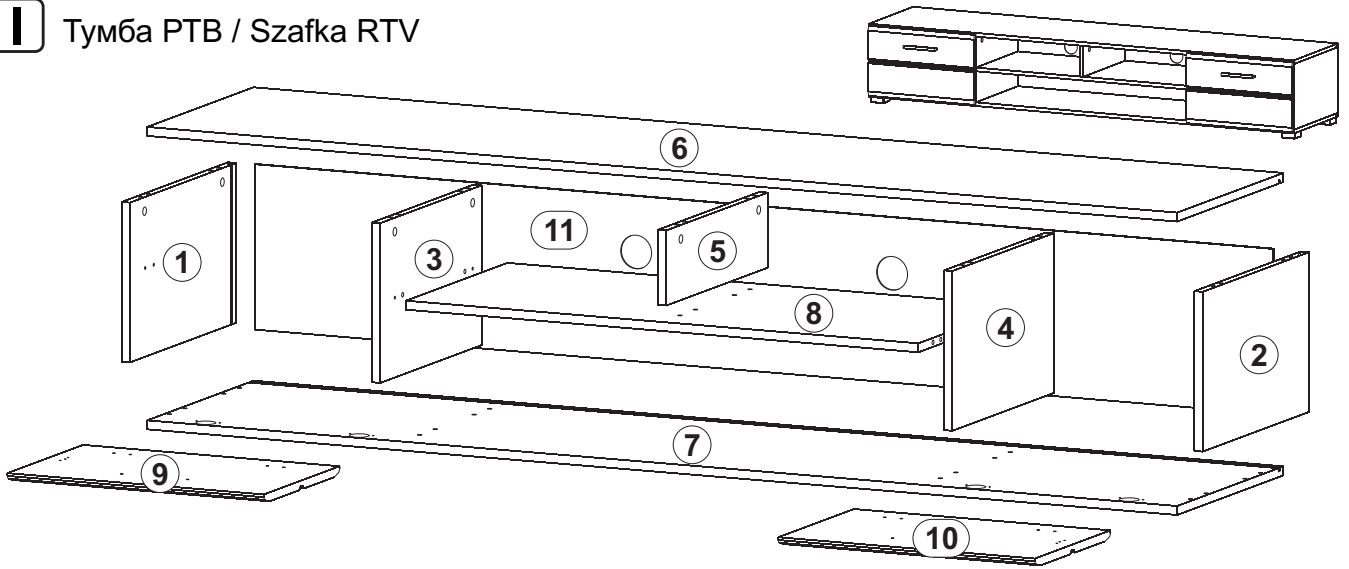

A	B	C	D	A	B	C	D		
1	SL1-101	285	437	1/4	7	SL1-207	2000	437	1/4
2	SL1-105	285	437	1/4	8	SL1-305	995	417	1/4
3	SL1-103	285	417	1/4	9	SL1-005	498	311	1/4
4	SL1-106	285	417	1/4	10	SL1-006	498	311	1/4
5	SL1-115	134	417	1/4	11	SL1-906	1977	295	1/4
6	SL1-206	2000	437	1/4					



**1**

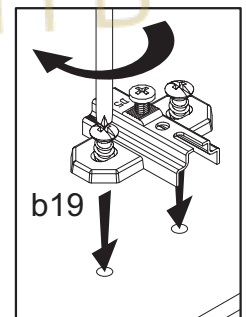
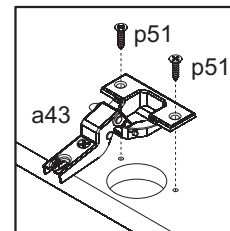
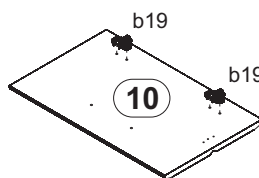
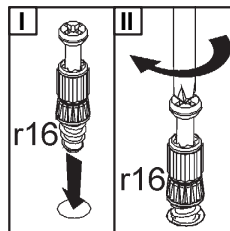
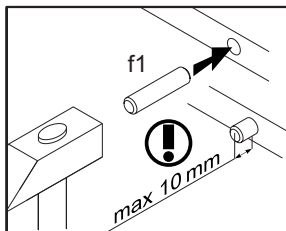
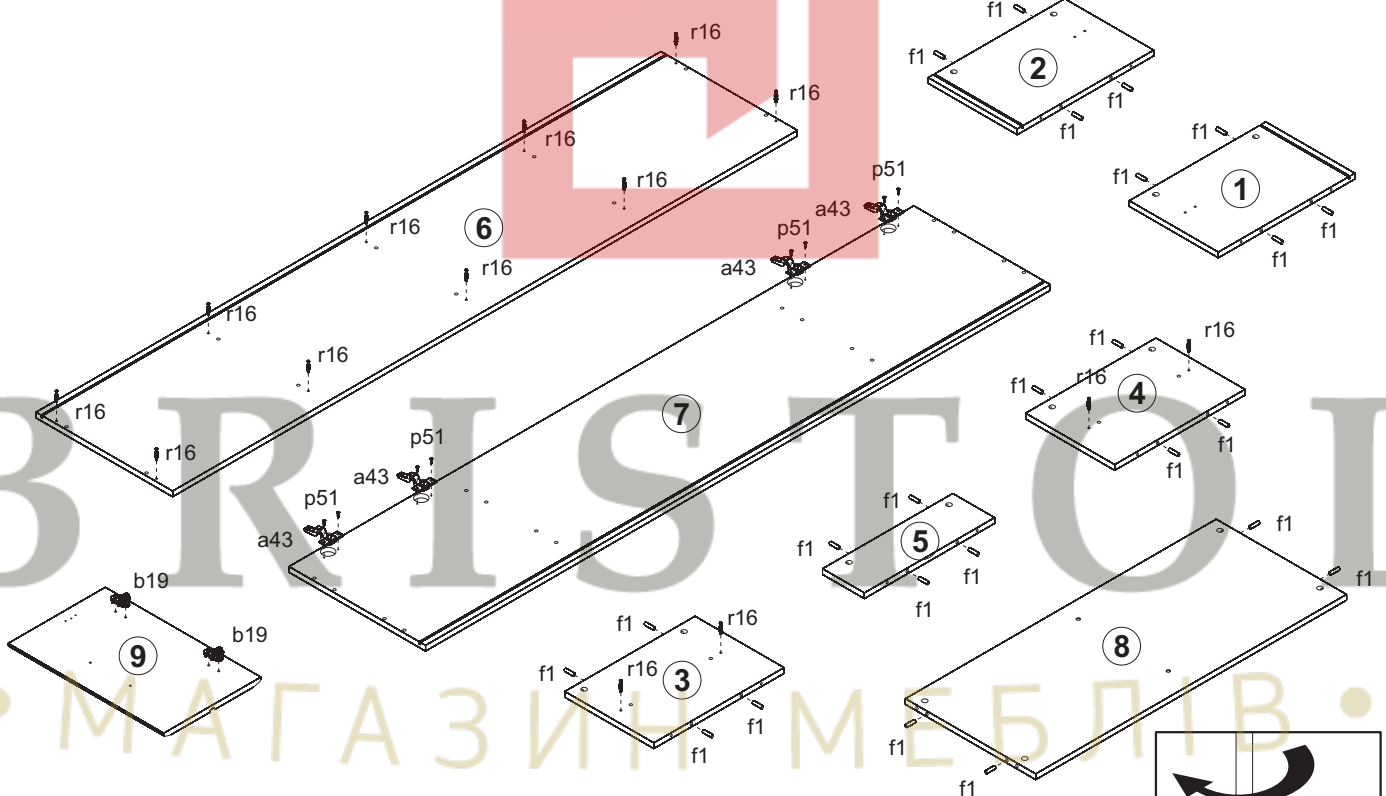
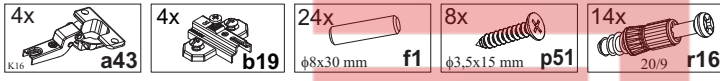

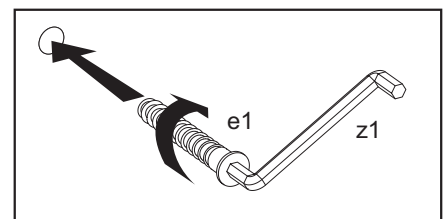
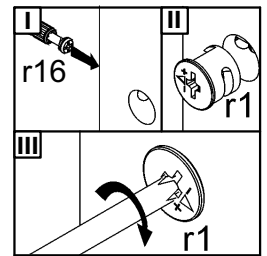
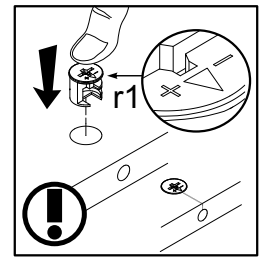
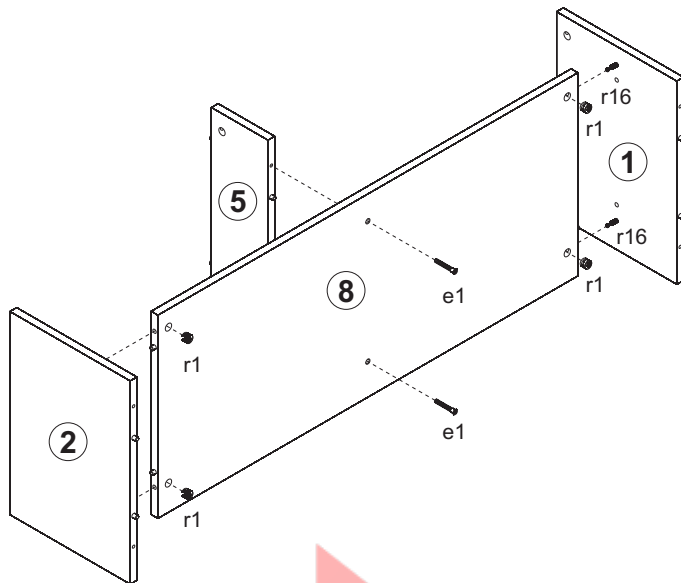
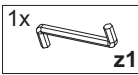
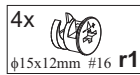
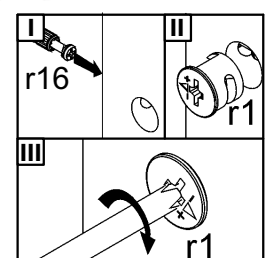
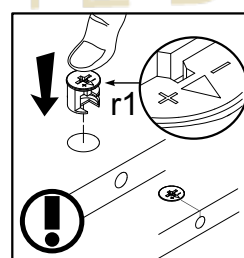
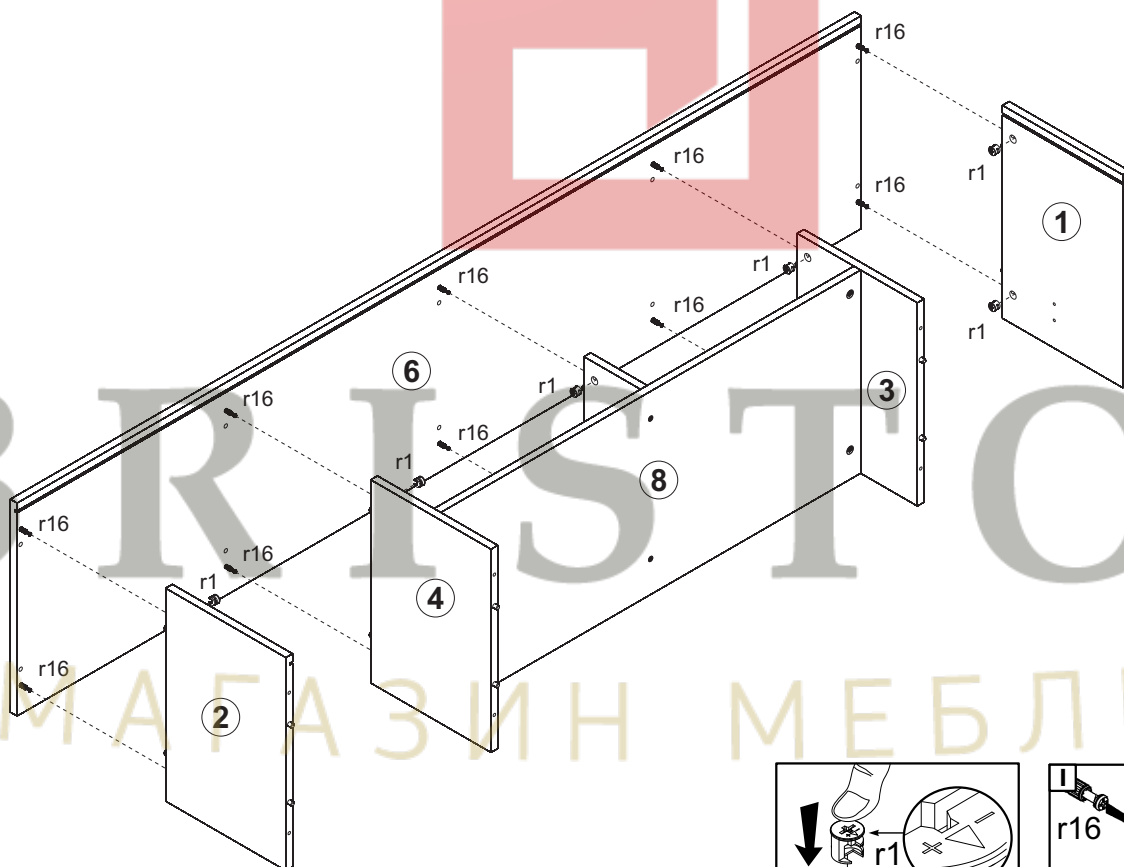
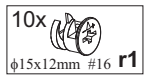
**2****3**

# 4

8x  
φ7x50 mm  
e1

1x  
z1

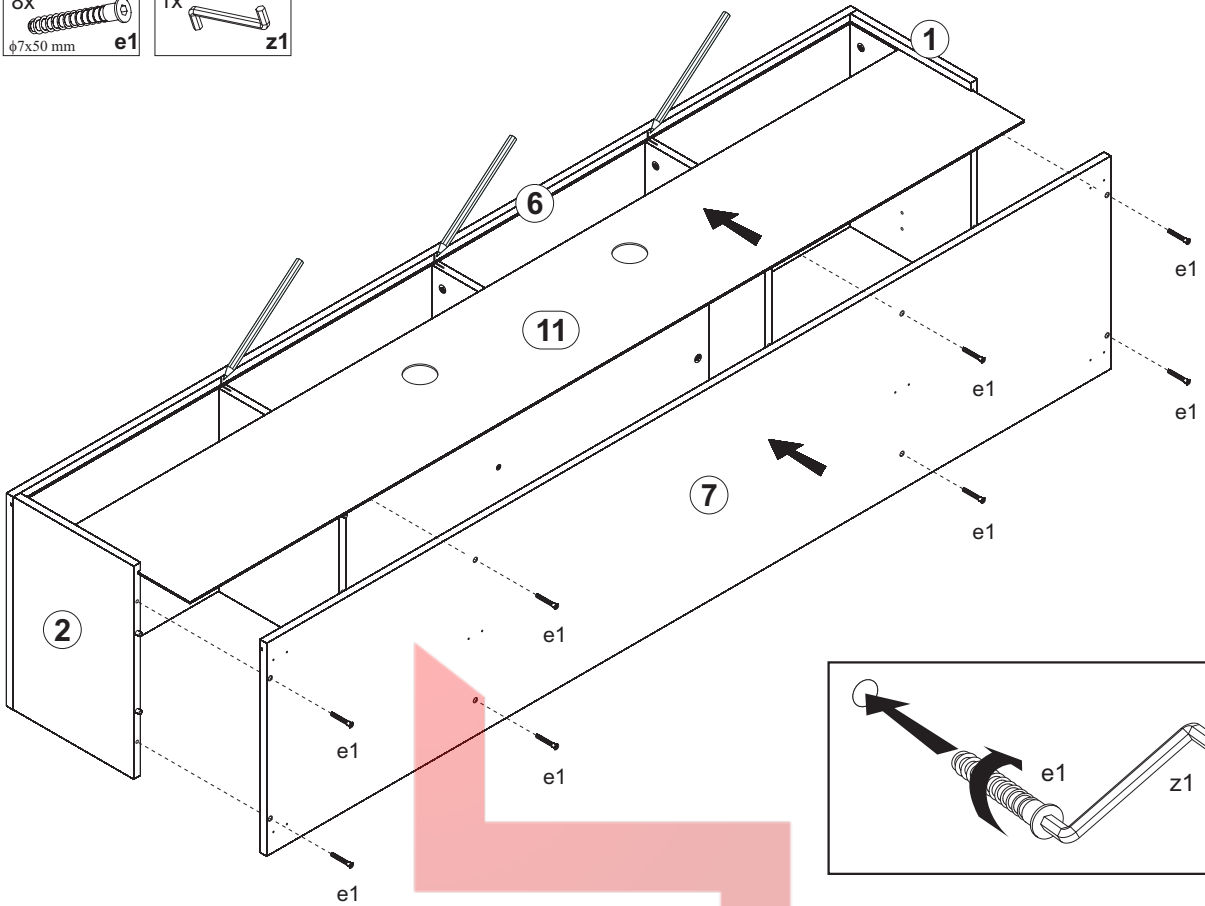

# 5

6x  
k55

12x  
φ4x35 mm  
p6

10x  
l2

19x  
l1

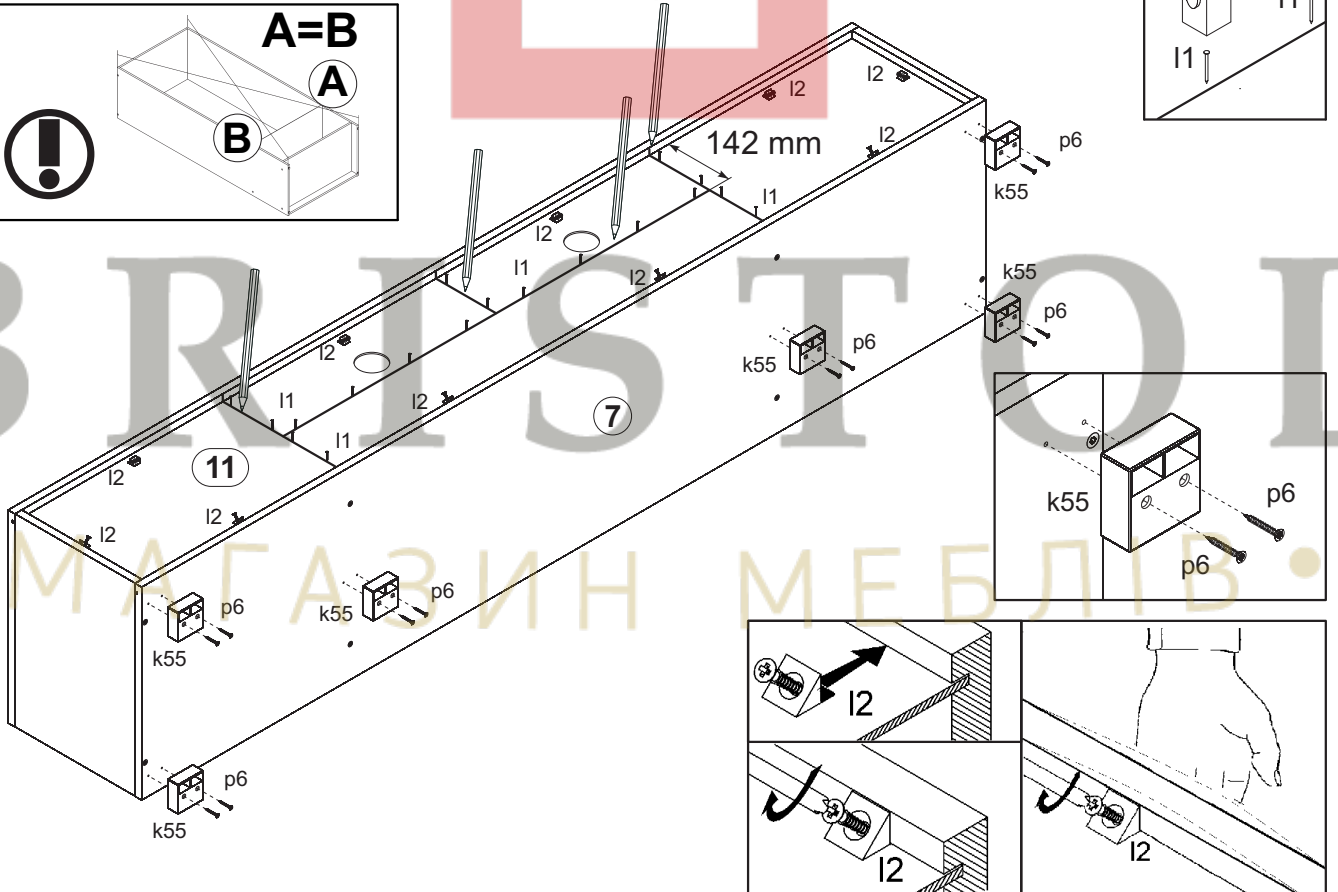
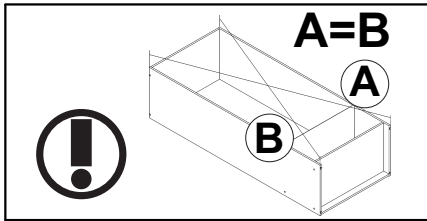
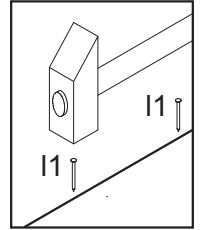

6

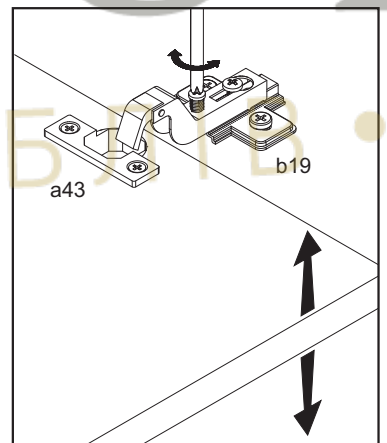
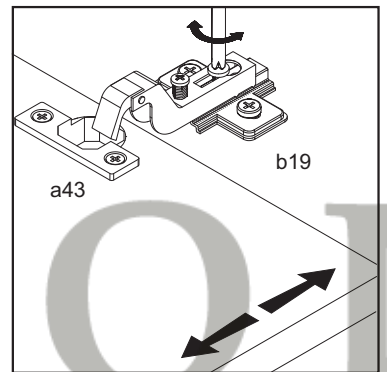
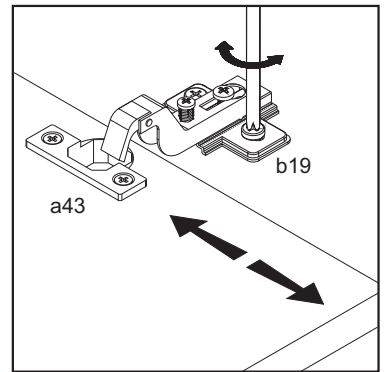
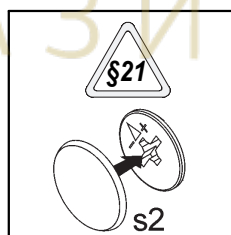
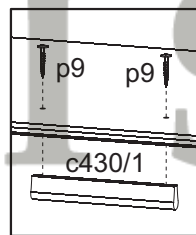
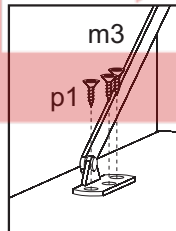
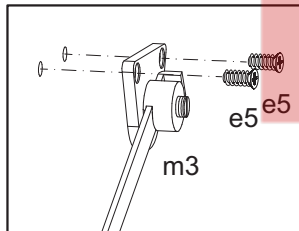
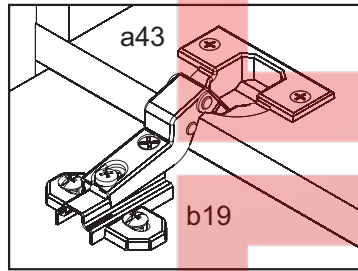
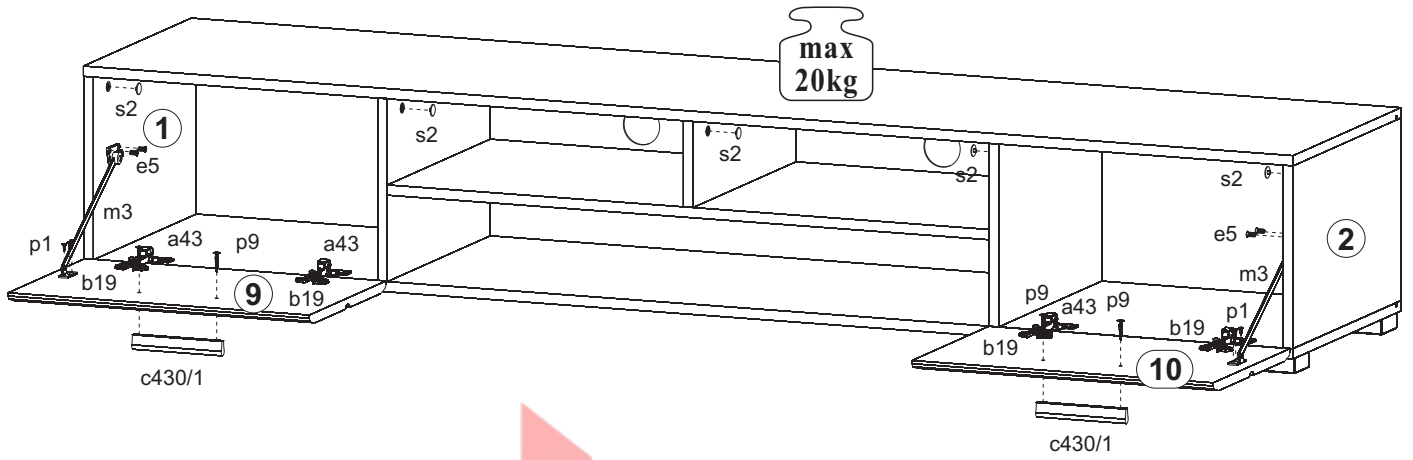
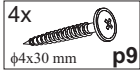
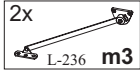
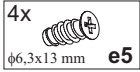

**II** Бар / Bar

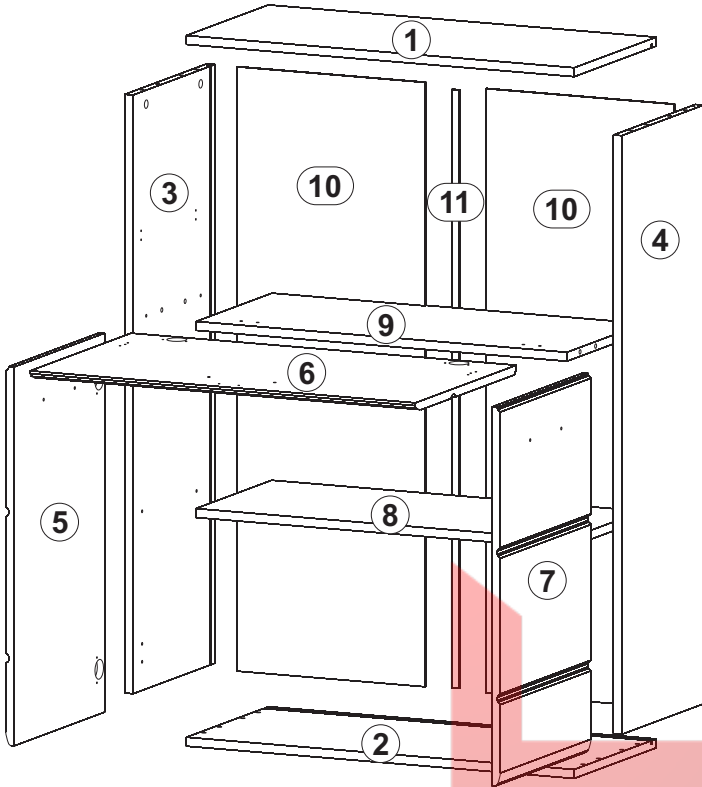
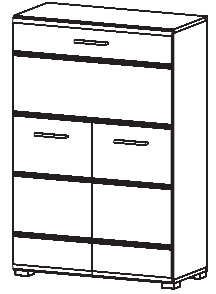

A	B	C	D	
1	SL1-210	753	337	3/4
2	SL1-211	753	337	3/4
3	SL1-123	1068	337	4/4
4	SL1-119	1068	337	4/4
5	SL1-008	373	676	3/4
6	SL1-009	415	748	3/4
7	SL1-010	373	676	3/4
8	SL1-306	720	312	4/4
9	SL1-307	720	317	4/4
10	SL1-909	1078	365	4/4
11	LH-1067	1067	14	4/4

**7**

- 4x a44
- 2x a68
- 6x b19
- 4x  $\phi 5 \times 17$  mm d1
- 12x  $\phi 8 \times 30$  mm f1
- 12x  $\phi 3,5 \times 15$  mm p51
- 8x 20/9 r16

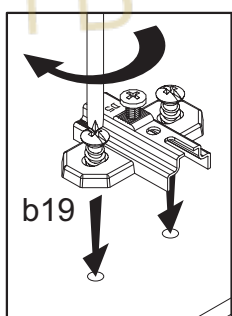
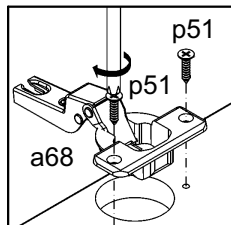
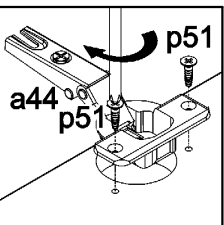
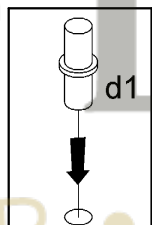
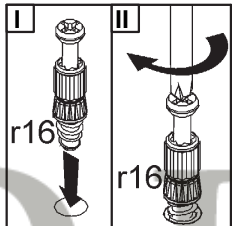
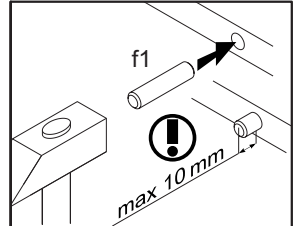
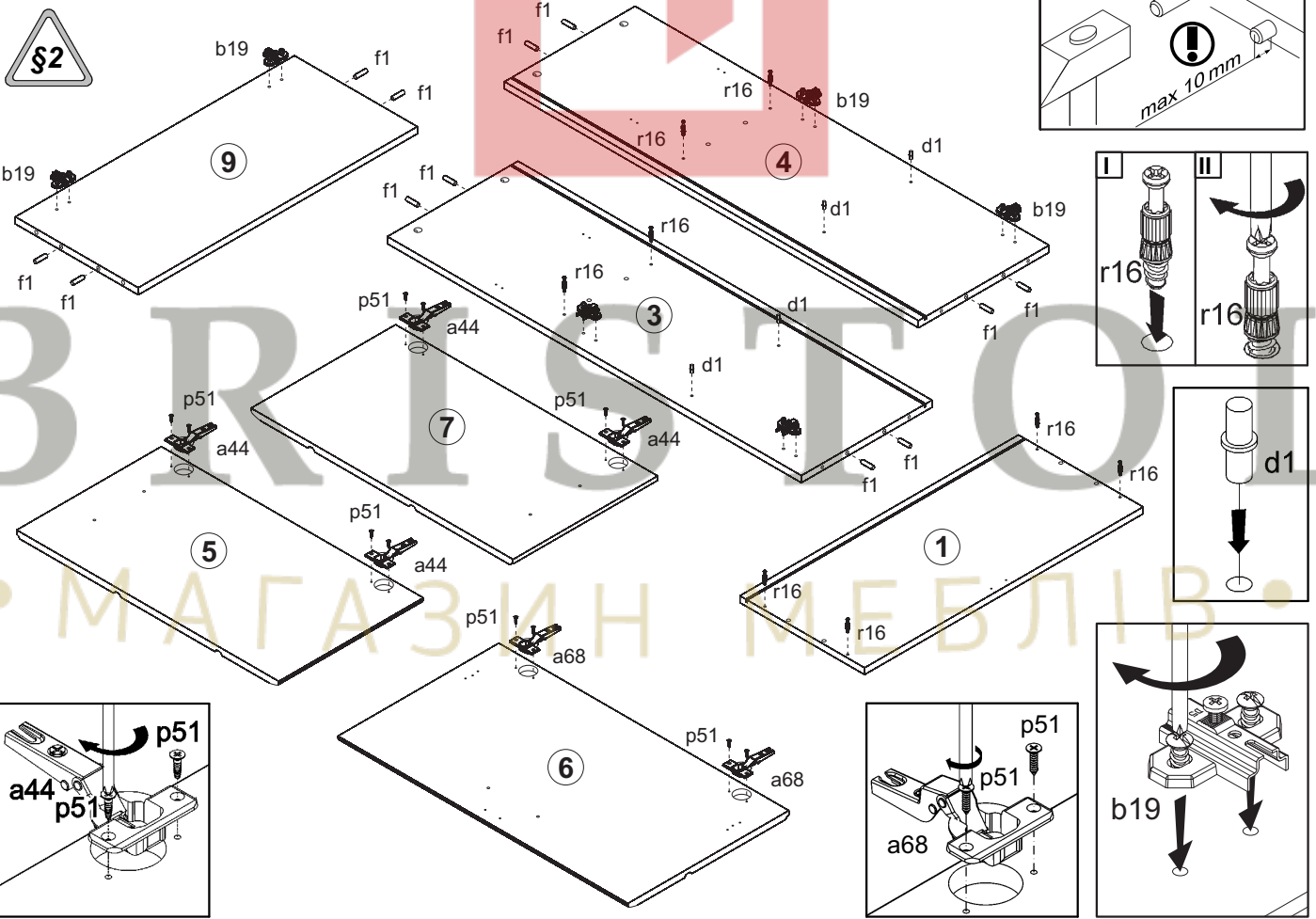

8



4x   $\phi 15 \times 12 \text{mm}$  #16 r1

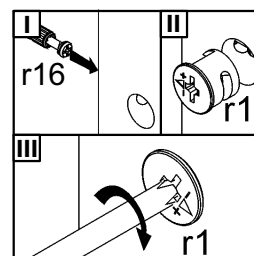
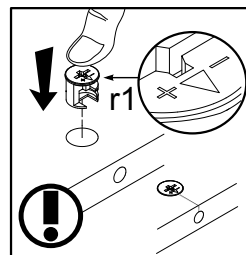
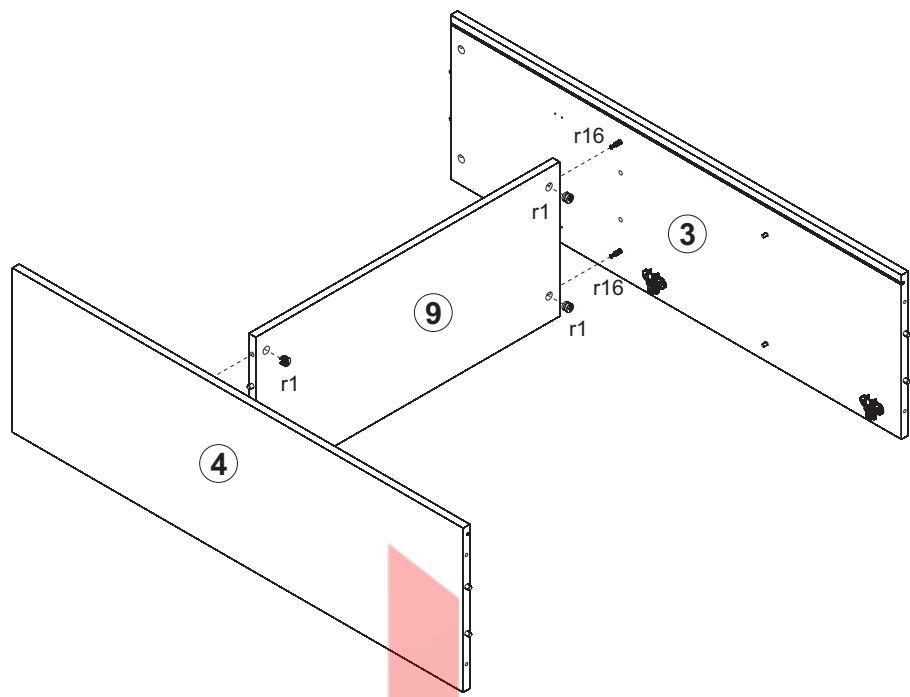

9

4x   $\phi 15 \times 12 \text{mm}$  #16 r1

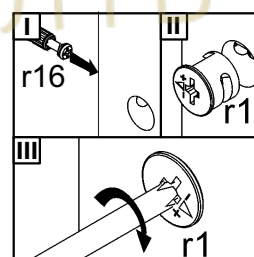
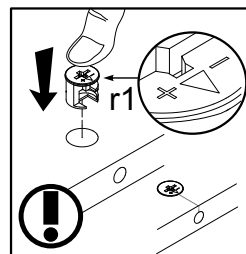
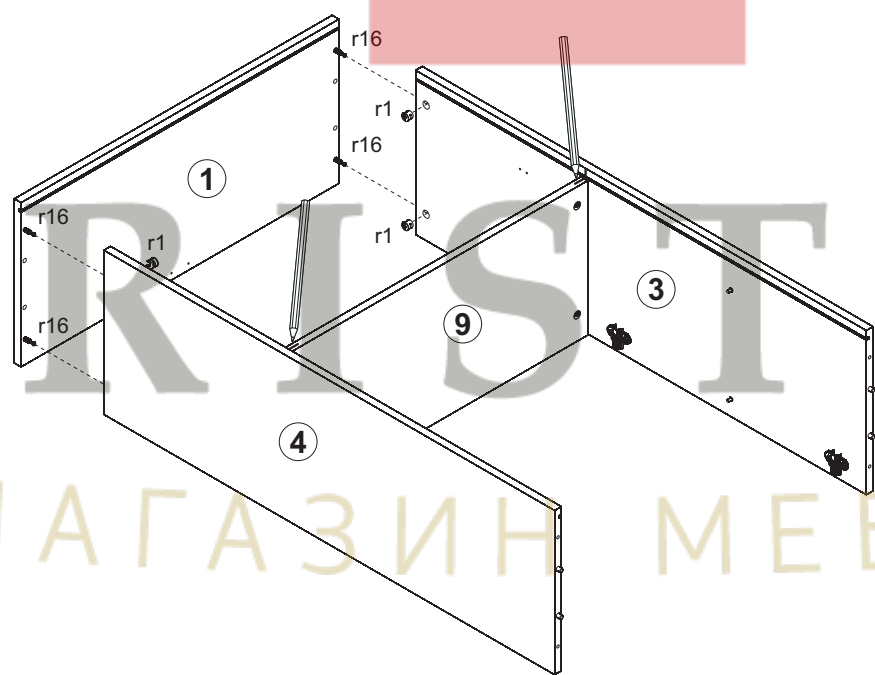



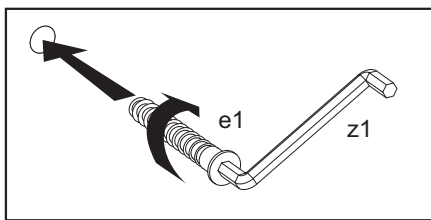
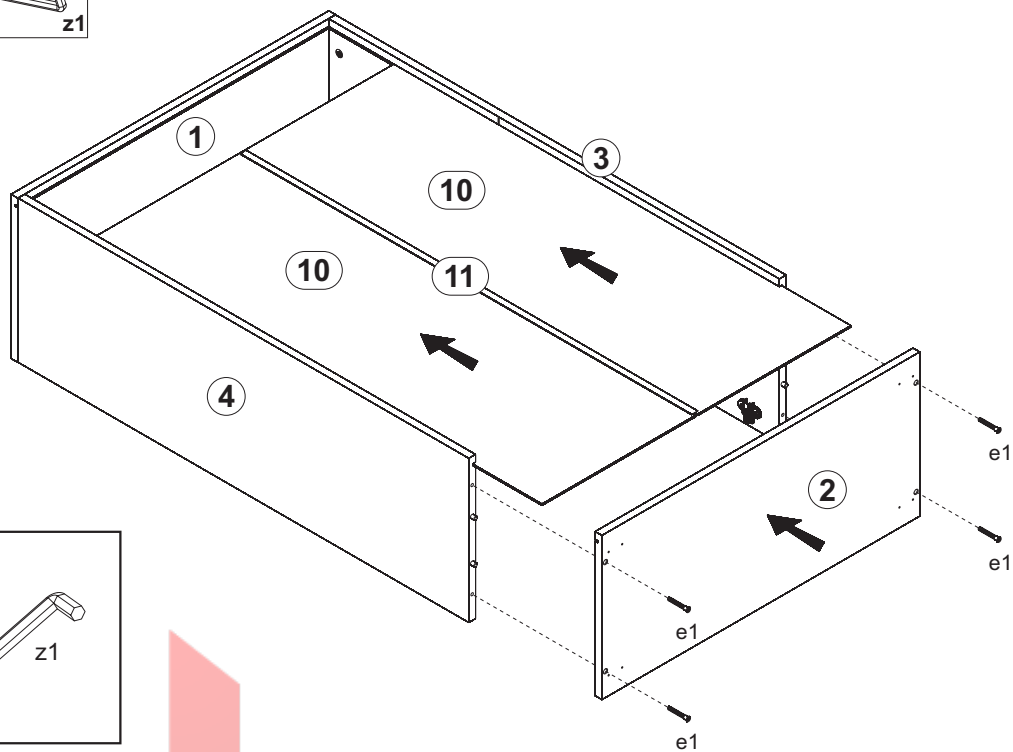
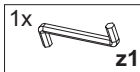
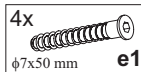

# 10

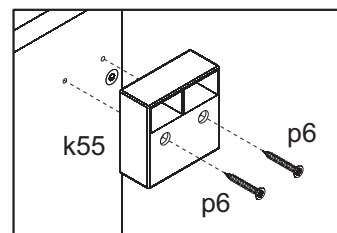
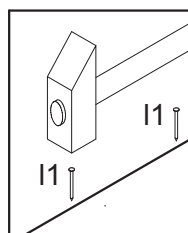
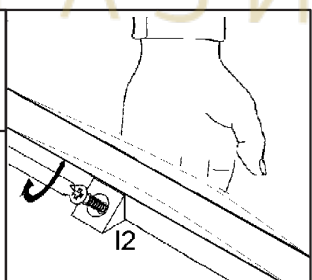
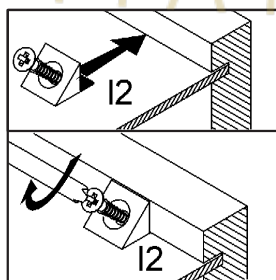
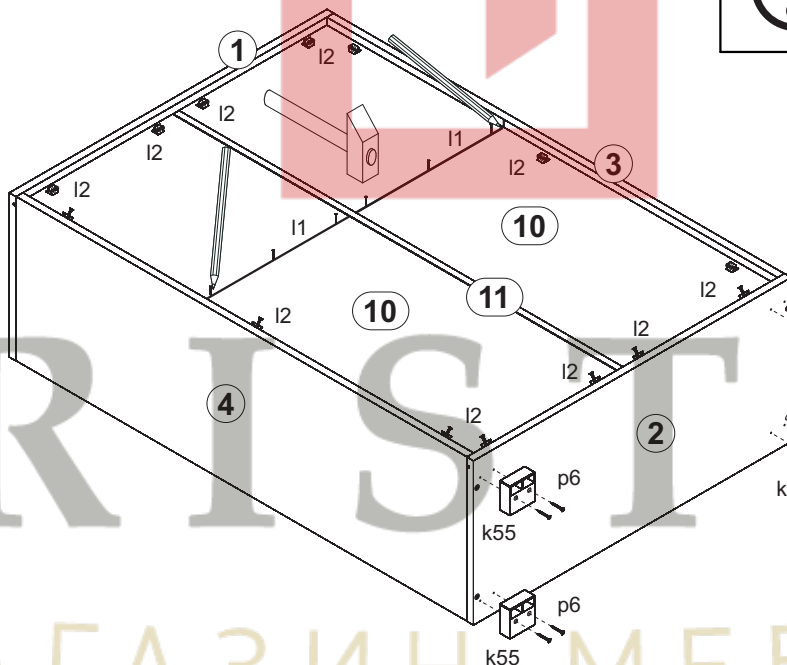
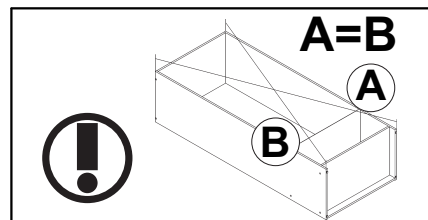
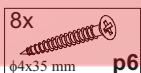
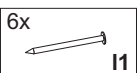

# 11



# 12

1x  n14  
81x21x15/1,5mm

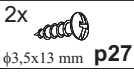
2x  p27  
φ3,5x13 mm

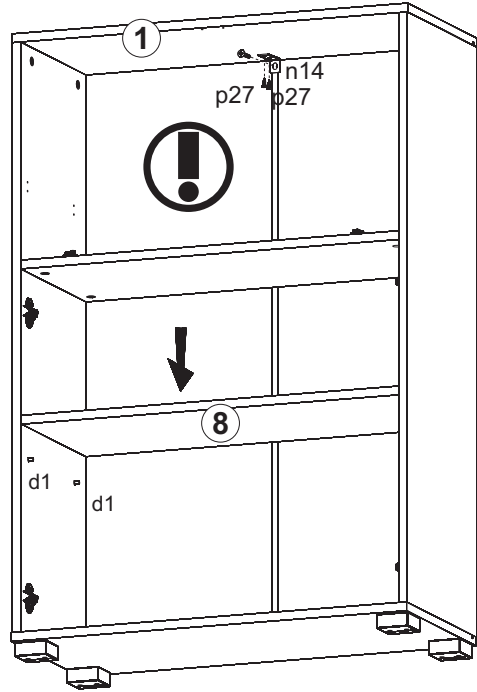
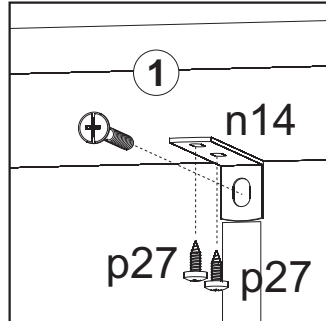
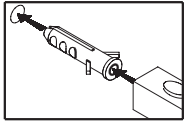
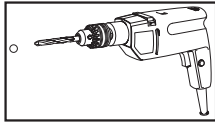
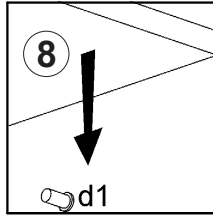
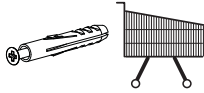

# 13

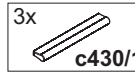
3x  c430/1

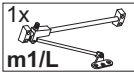
1x  m1/L

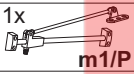
1x  m1/P

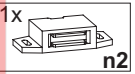
1x  n2

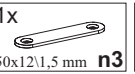
1x  n3  
50x12x1,5 mm

6x  p1  
φ3,5x13 mm

6x  p9  
φ4x30 mm

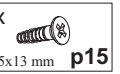
2x  p15  
φ2,5x13 mm

2x  p27  
φ3,5x13 mm

8x  p50  
φ2,9x24 mm

8x  s2  
ø16

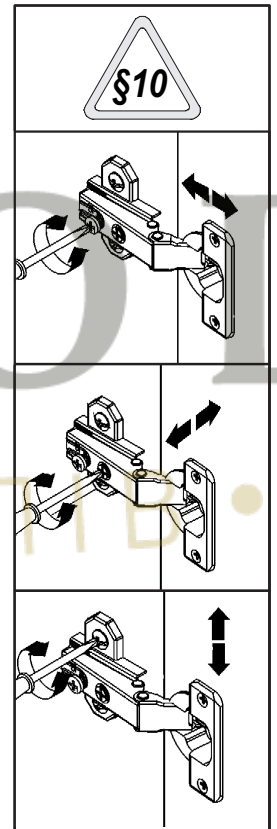
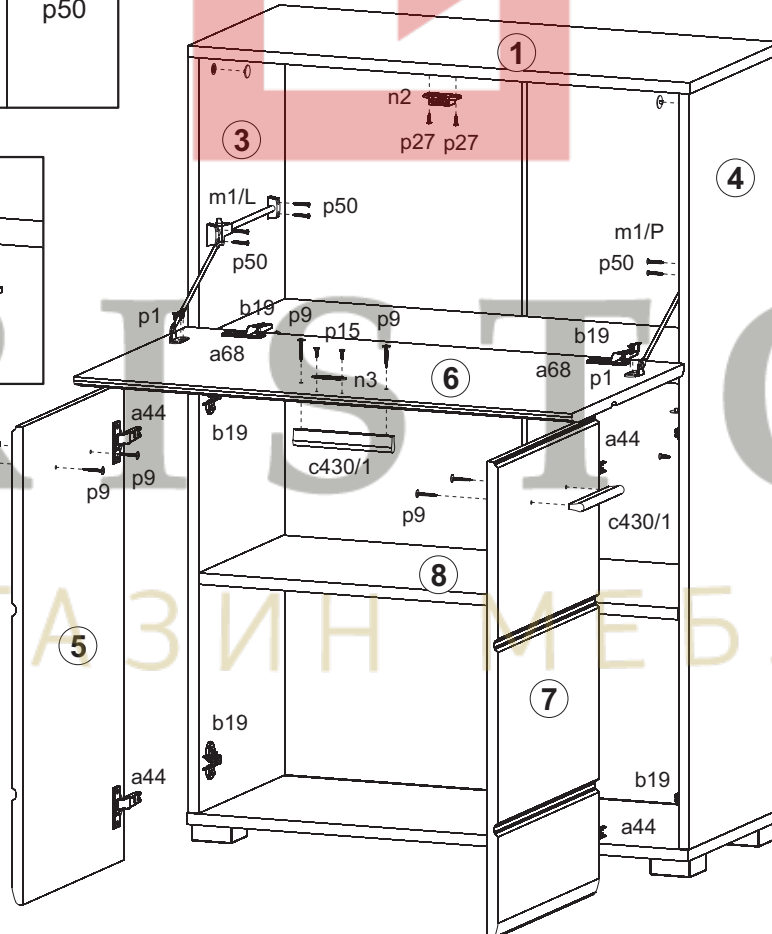
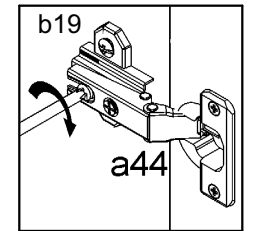
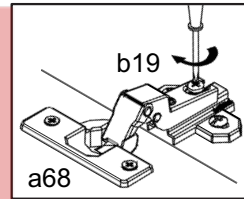
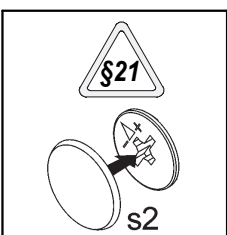
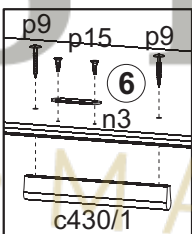
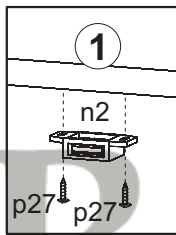
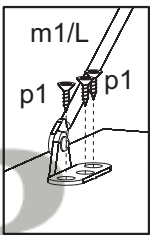
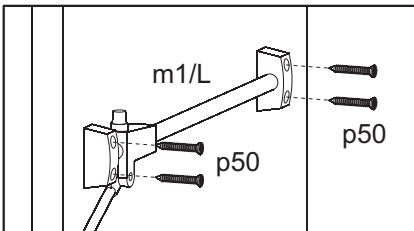



Вітрина / Витрина / Witryna

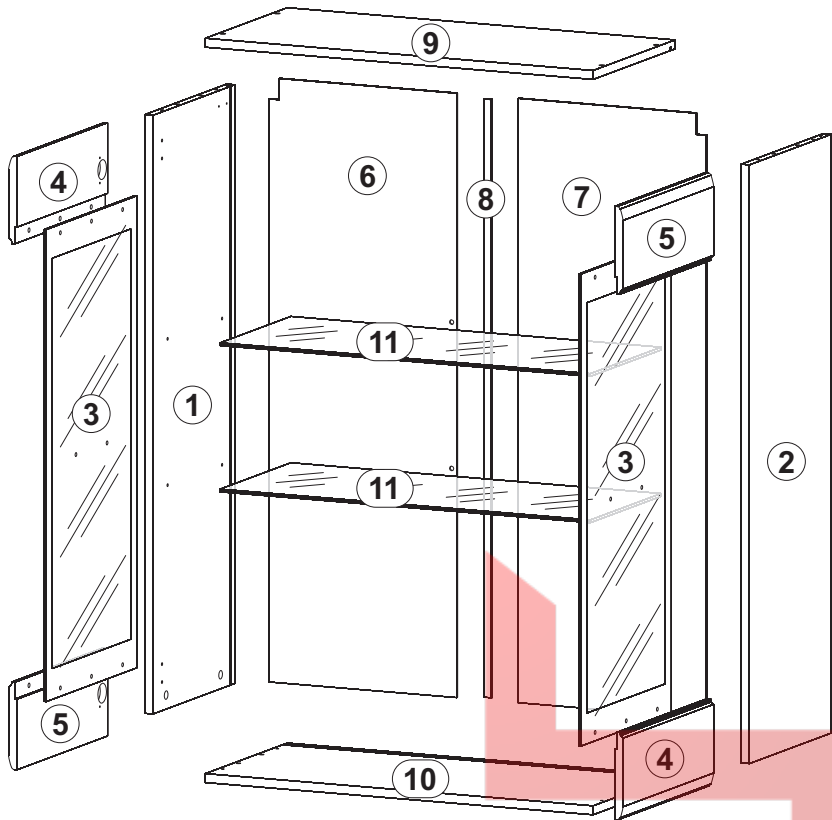
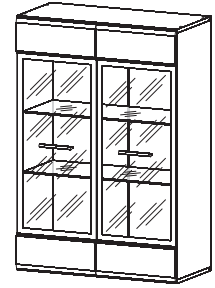

A	B	C	D	
1	SL1-116	1068	337	2/4
2	SL1-117	1068	337	2/4
3	SL1-511	842	372	2/4
4	SL1-014	373	156	2/4
5	SL1-011	373	156	2/4
6	SL1-907	1078	365	2/4
7	SL1-905	1078	365	2/4
8	LH-1067	1067	14	2/4
9	SL1-208	753	337	3/4
10	SL1-209	753	337	3/4
11	SL1-510	718	292	3/4

14

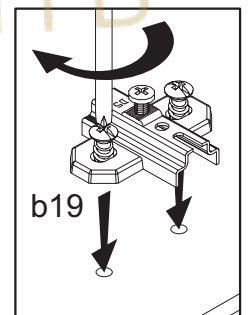
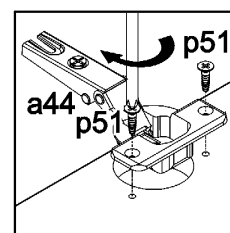
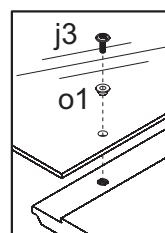
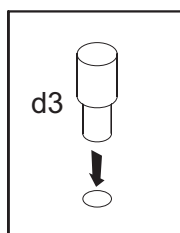
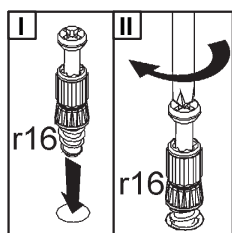
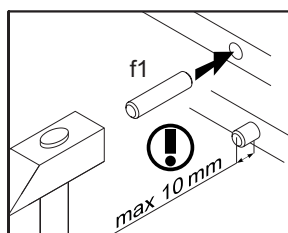
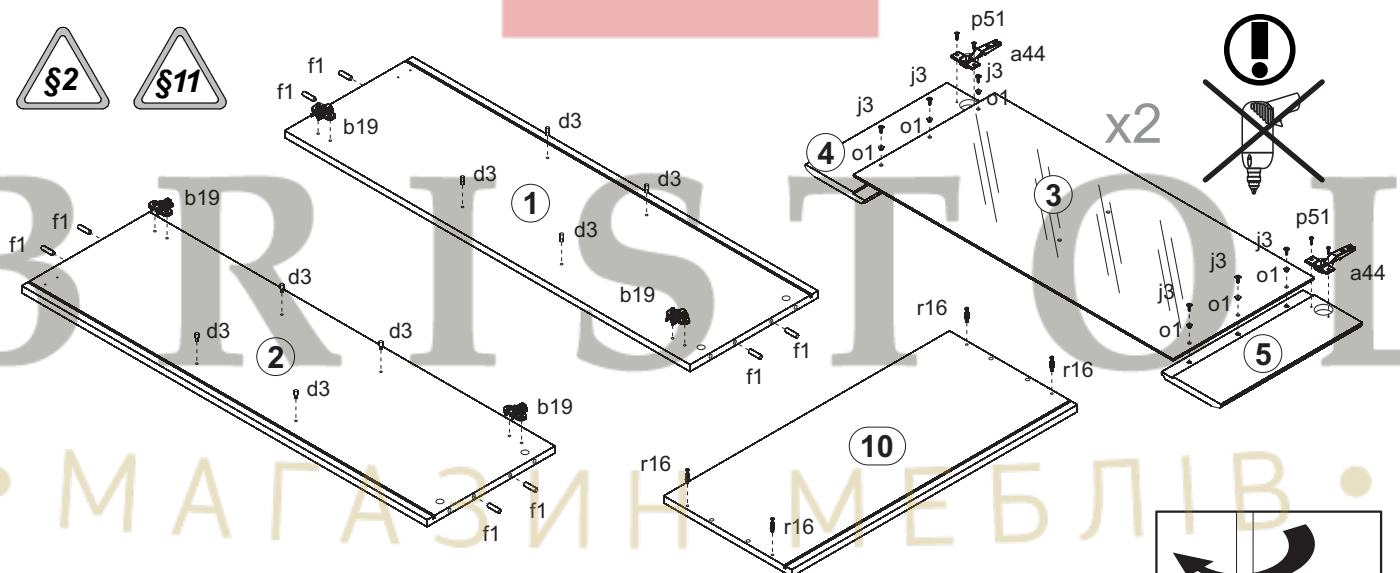

# 15

4x   $\phi 15 \times 12 \text{ mm}$  #16 r1

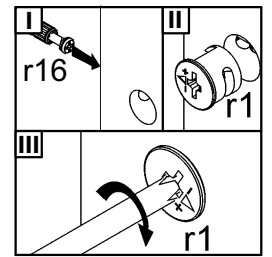
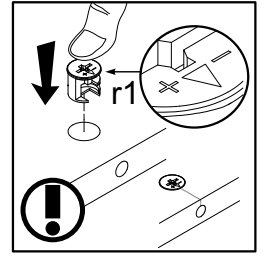
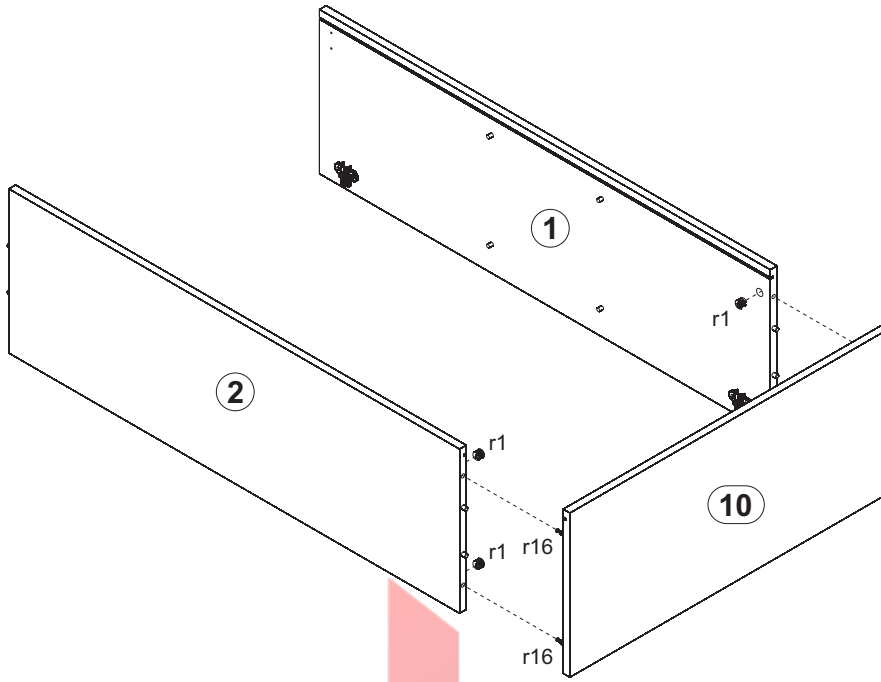

# 16

4x   $\phi 7 \times 50 \text{ mm}$  e1

1x  z1

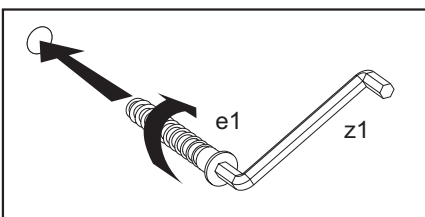
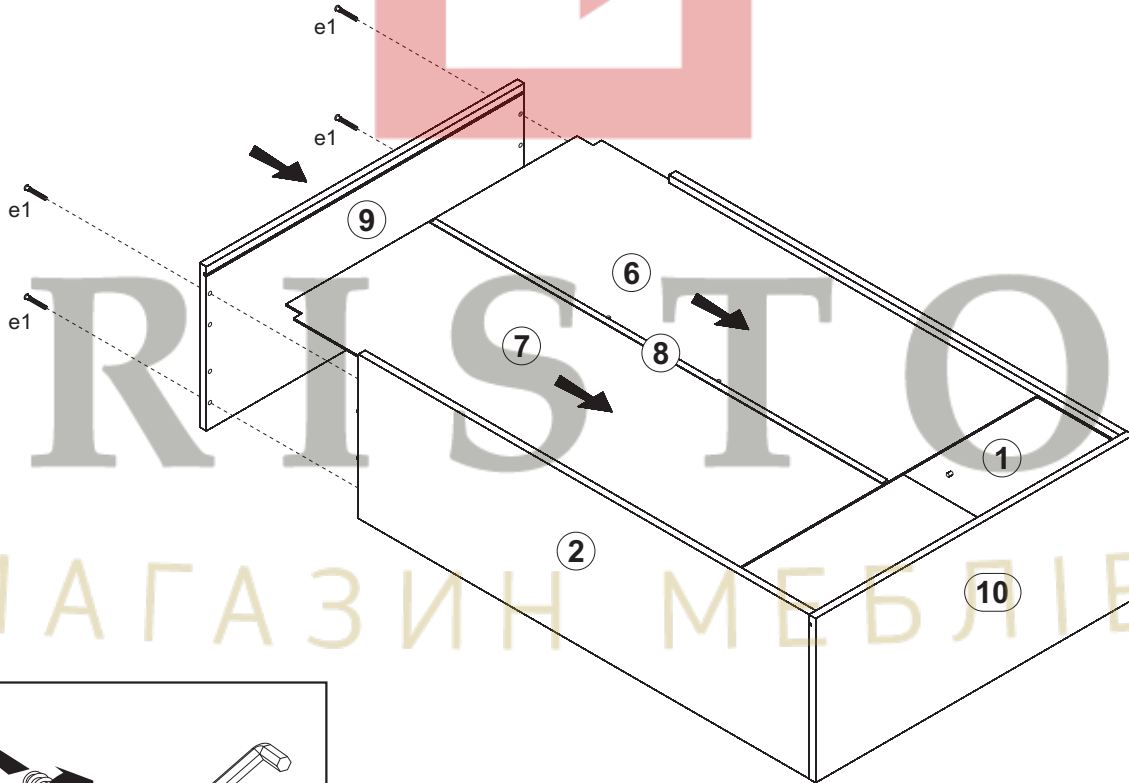

# 17

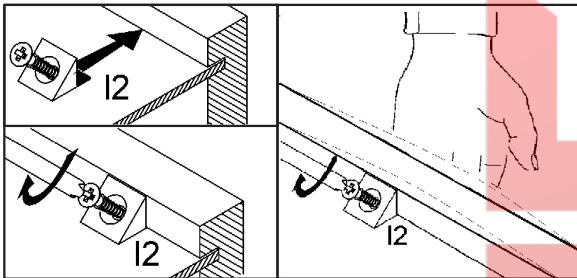
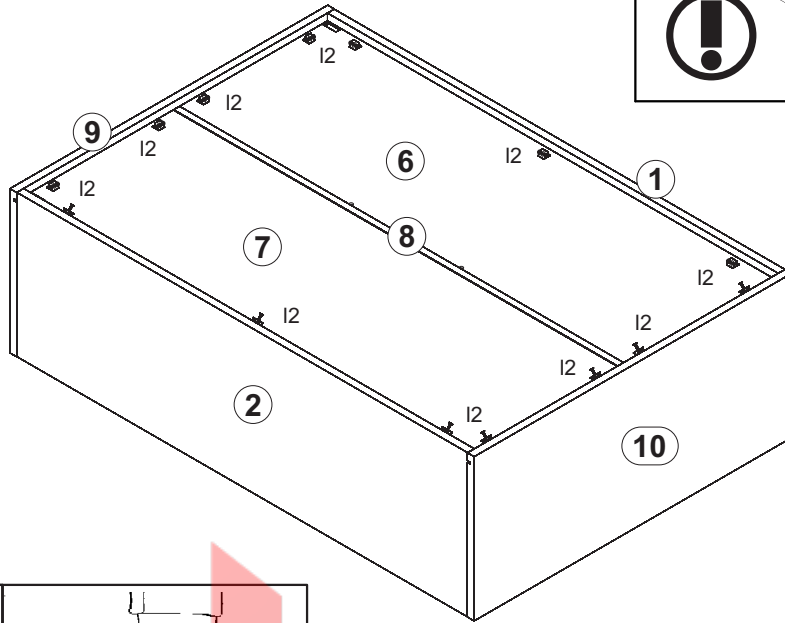
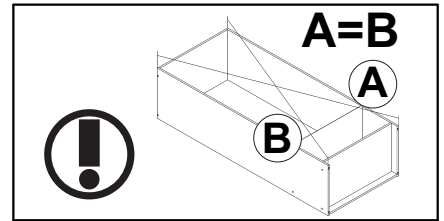

# 18

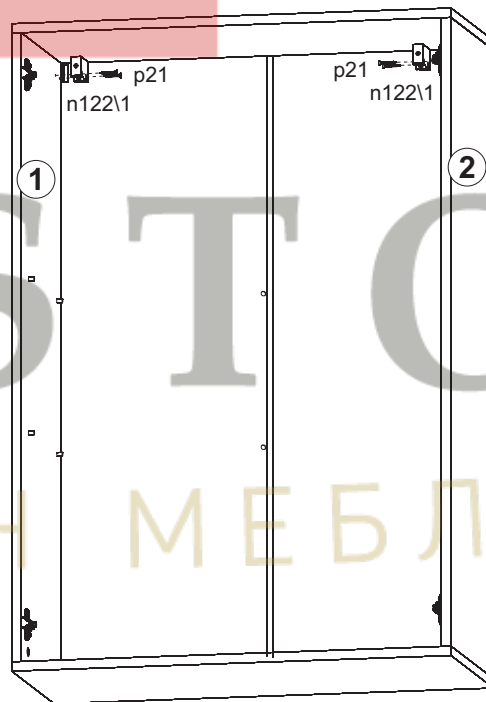
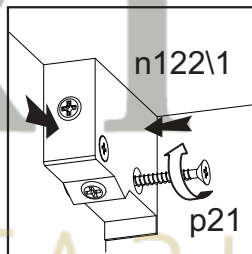
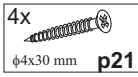
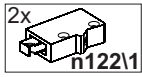

# 19

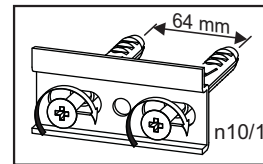
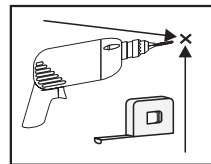
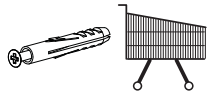
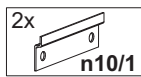

25 mm

64 mm

64 mm

25 mm

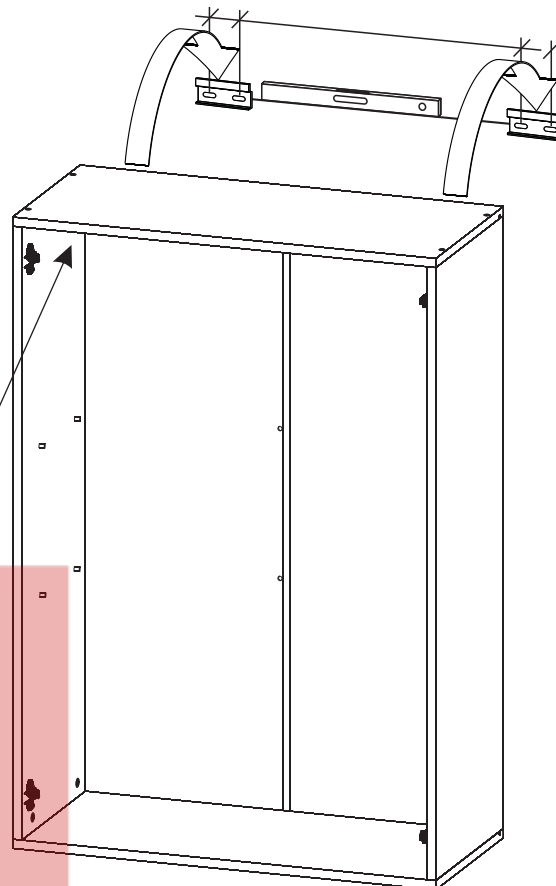
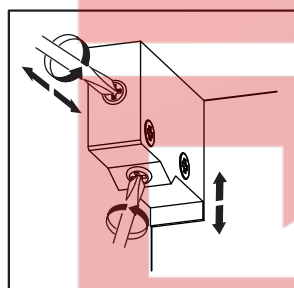
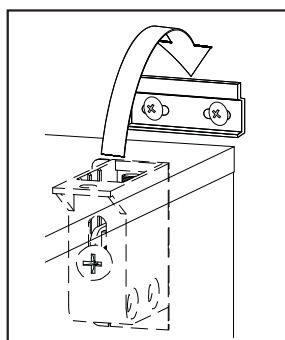
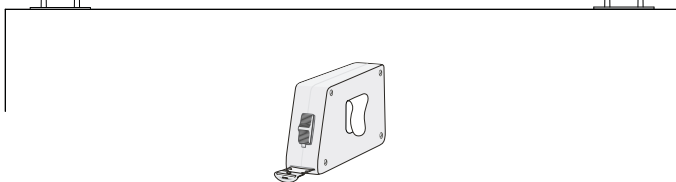

# 20

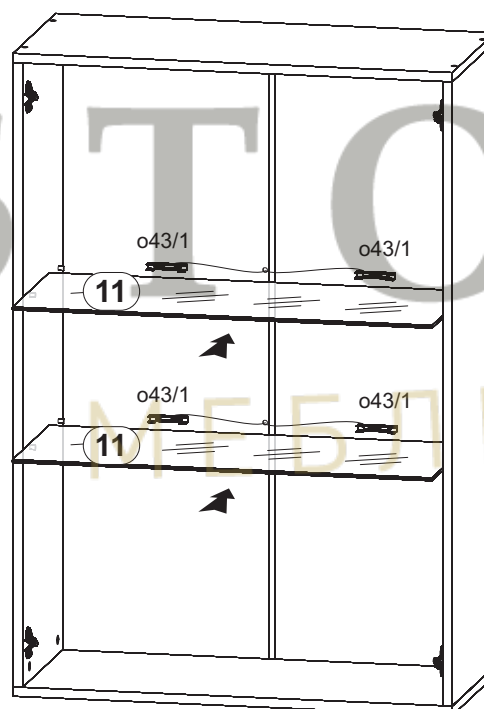
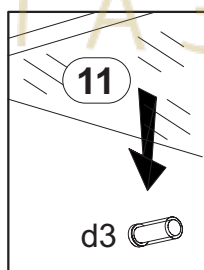
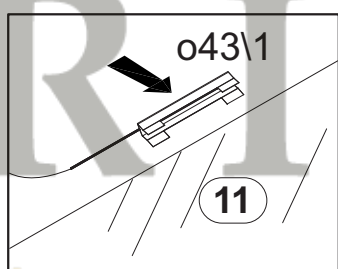
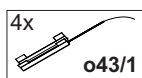

# 21

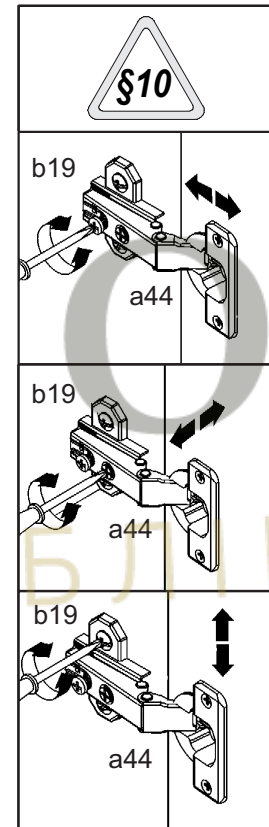
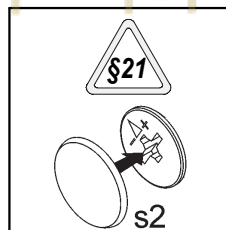
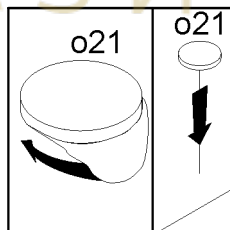
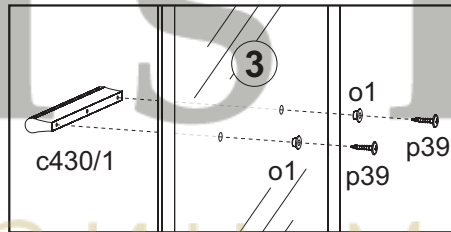
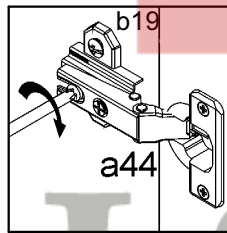
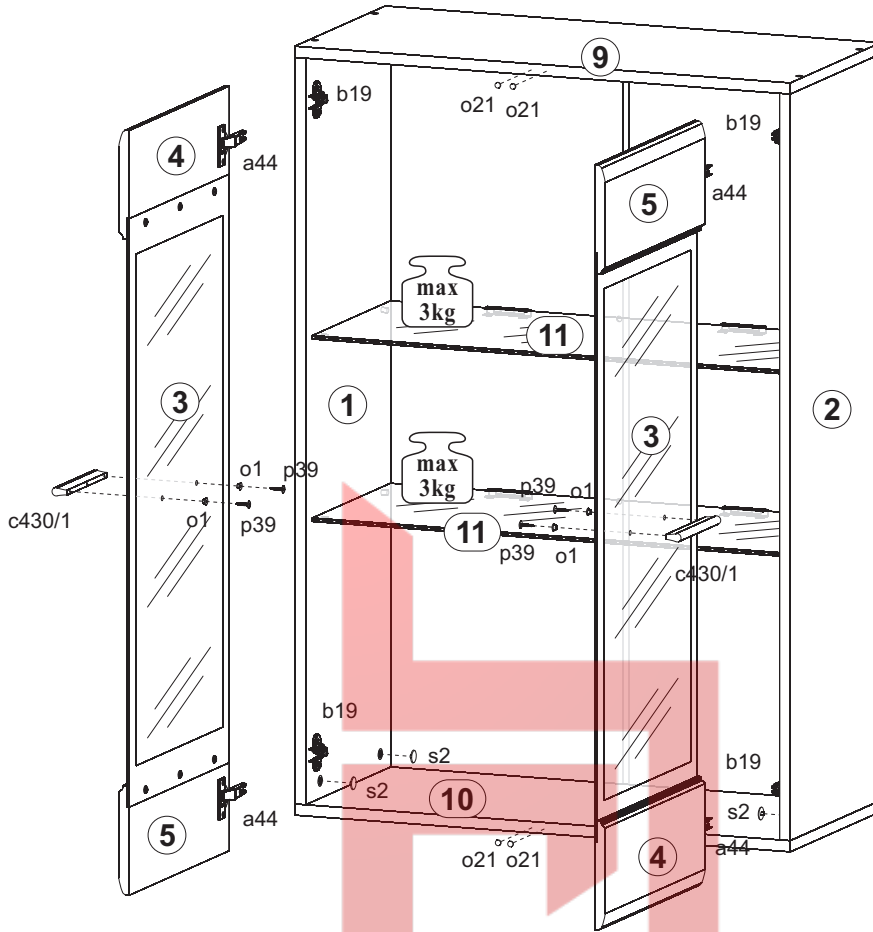
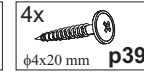
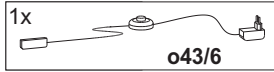
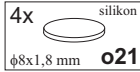
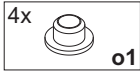

# IV Полиця / Полка / Półka

max  
3kg

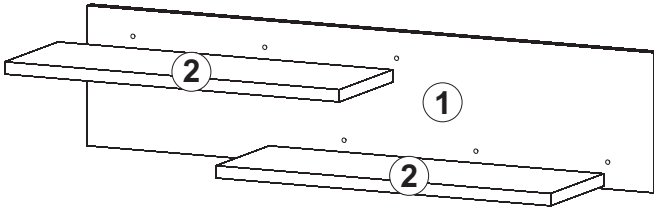

A	B	C	D
1	SL1-506	1100	250
2	SL1-304	650	219

## 22

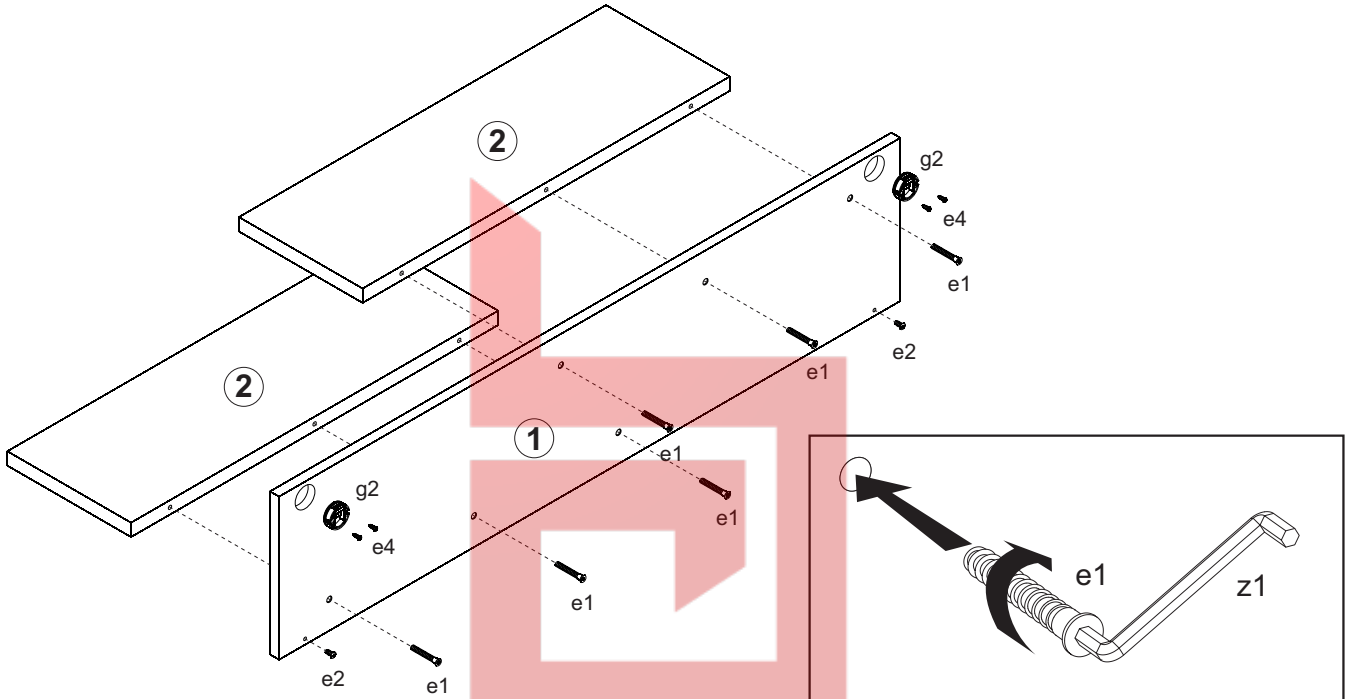
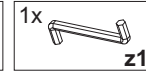
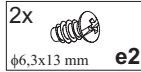
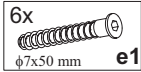

## 23

